

Holdern

A Modern Estate Agent



7 Riverview, Loughborough, LE12 8LL

£250,000

An excellent opportunity to purchase this substantial mid-town house offering large lounge and extended dining kitchen, ground floor shower room, three bedrooms and family bathroom. The property also has a sizeable rear garden and is superbly located for ease of access to the A6 bypass and the amenities of Sileby and Barrow Upon Soar villages.

The accommodation comprises an entrance hallway with a UPVC double-glazed front door, a staircase rising to the first floor landing and access into the lounge.

The lounge has a UPVC double-glazed window to the front elevation, a focal log burning stove, a useful under stairs storage cupboard and a door giving access into the living kitchen.

The living kitchen is a has been extended to include a range of units with work-surfacing over, inset sink and drainer, SMEG range cooker and hob, extractor fan, integrated fridge freezer. There is also plentiful space for a large dining set and two velux skylights and french doors allowing in plentiful light to this space. Accessed from here is a ground floor shower room that also allows for a Utility space.

The first floor landing gives access to all rooms with bedroom one being situated at the front of the property with a window to the front elevation with far reaching views over the Soar Valley and River Soar. Bedroom two is situated at the rear of the property and has a UPVC double-glazed window to the rear elevation overlooking the rear garden. Bedroom three also has a UPVC double-glazed window to the rear. The bathroom has a three piece suite comprising a low-level flush WC, wall mounted wash hand basin and a panelled bath with shower over.

Outside, the property is set back from the road with a small paved area to the front of the property. Outside rear, the property has a raised decking area and a sizeable rear garden with a large lawn space.

Disclaimer

1. Intending purchasers will be asked to produce identification documentation.

2. While we endeavour to make our sales particulars fair, accurate, and reliable, they are only a general guide to the property.

3. The measurements indicated are supplied for guidance only and, as such, must be considered incorrect.

4. Please note we have not tested the services or any of the equipment or appliances in this property; accordingly, we strongly advise prospective buyers to commission their survey or service reports before finalising their offer to purchase.

5. These particulars are issued in good faith but do

not constitute representations of fact or form part of any offer or contract. The matters referred to in these particulars should be independently verified by prospective buyers. Neither Holders Estate Agents nor its agents have any authority to make or give any representation or warranty concerning this property.

Floor Plan



Riverview, Barrow Upon Soar

Holders
A Modern Estate Agent

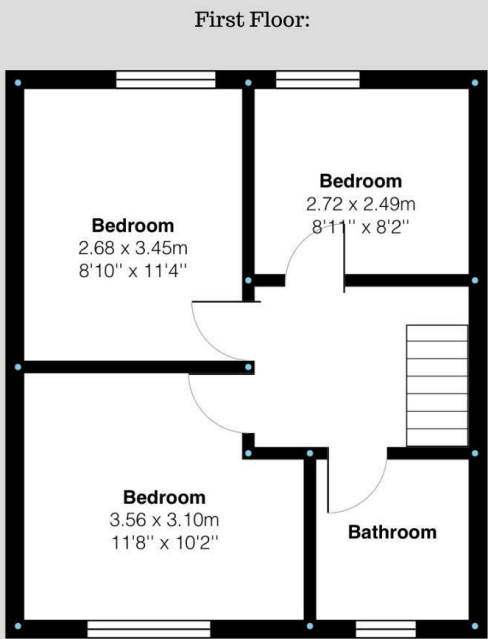

Riverview, Barrow Upon Soar

Holders
A Modern Estate Agent

Area Map

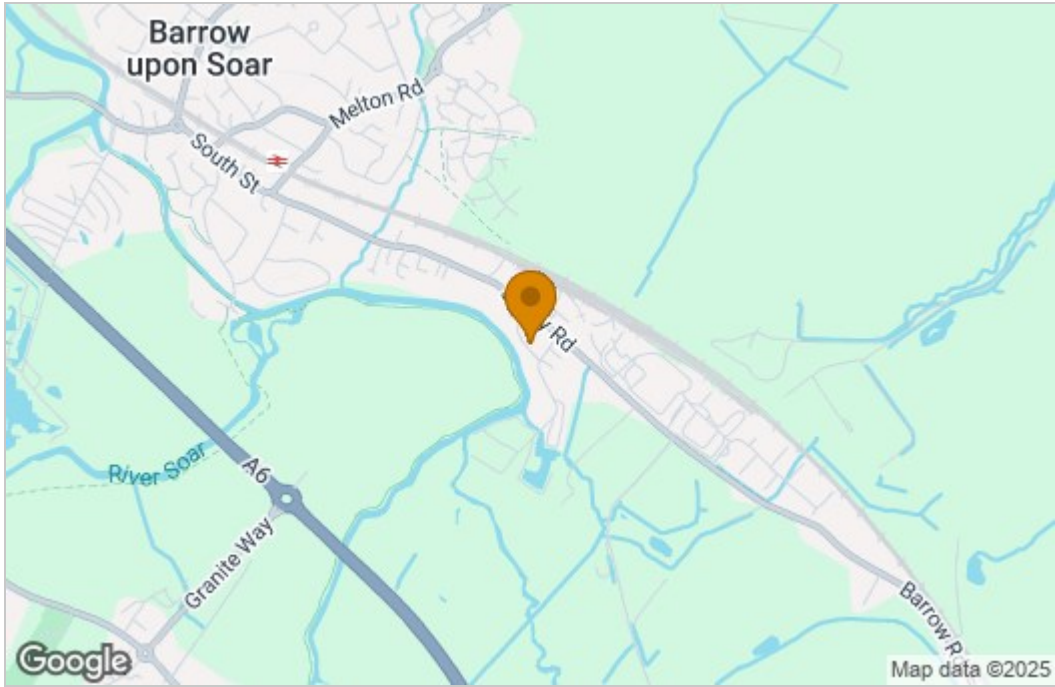

Energy Efficiency Graph

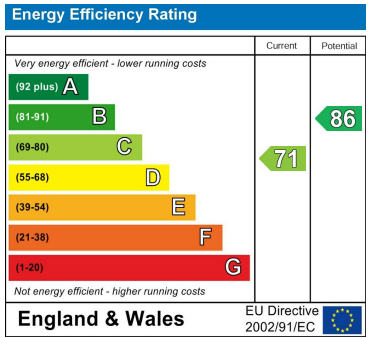

These particulars, whilst believed to be accurate are set out as a general outline only for guidance and do not constitute any part of an offer or contract. Intending purchasers should not rely on them as statements of representation of fact, but must satisfy themselves by inspection or otherwise as to their accuracy. No person in this firms employment has the authority to make or give any representation or warranty in respect of the property.