

Holden's

A Modern Estate Agent



207 Rendell Street, Loughborough, LE11 1LN

£130,000

Occupying an attractive setting adjacent to the Grand Union Canal. A spacious and modern purpose built first floor apartment including TWO DOUBLE BEDROOMS and a communal garden area. The apartment benefits from gas fired central heating and is pleasantly positioned within this well established residential area having easy access to all town centre amenities.

This delightful property is nestled in a tranquil, secluded position adjacent to the picturesque Grand Union Canal, offering a peaceful retreat while still being conveniently situated within a well-established and highly sought-after residential area. Despite its peaceful setting, the home is just a few minutes' level walk from a wealth of town centre amenities. These include The Rushes Shopping Centre, where residents can find Tesco and Marks & Spencer Foodstores, making daily errands effortless. The location also provides excellent connectivity, with easy access to Loughborough train station for commuters, and proximity to Limehurst Academy, The University, and major road links. The Epinal Way inner ring road and the M1 Motorway at Junctions 23 and 24 are all within easy reach, ensuring smooth travel to surrounding areas and beyond.

LEASEHOLD

173 years remaining

£101.75 pcm service charge

Upon entering the property, you are welcomed into a communal entrance hall featuring a staircase that leads to the first-floor accommodation. The first-floor entrance hall is equipped with built-in storage cupboards, a telephone entry system for added security, and doors that lead to all main rooms, providing a practical and organised layout. The spacious lounge measures approximately 4.95m x 3.20m (16'3 x 10'6), featuring a glazed panel door opening to the side elevation, a window to the rear, and a radiator, creating a bright and inviting living space. The breakfast kitchen is well-appointed and includes a gas cooker point and is served by a main gas-fired boiler that supplies hot water and central heating. Windows to the front and side elevations flood the room with natural light.

The master bedroom is generously proportioned at approximately 4.95m x 2.74m (16'3 x 9'0), featuring a rear-facing window and a radiator, offering a comfortable retreat. The second bedroom, measuring about 4.95m x 2.67m (16'3 x 8'9), also has a rear window and radiator, making it suitable for guests, a home office, or additional family members. The bathroom comprises a modern walk in shower, w/c and wash hand basin.

Externally, the property benefits from allocated car parking facilities, ensuring parking is straightforward and secure. Overall, this home combines a peaceful, picturesque setting with excellent local amenities and transport links, making it an ideal choice for those seeking comfortable living in a popular and well-connected community.

Agent Note:

Floor Plan

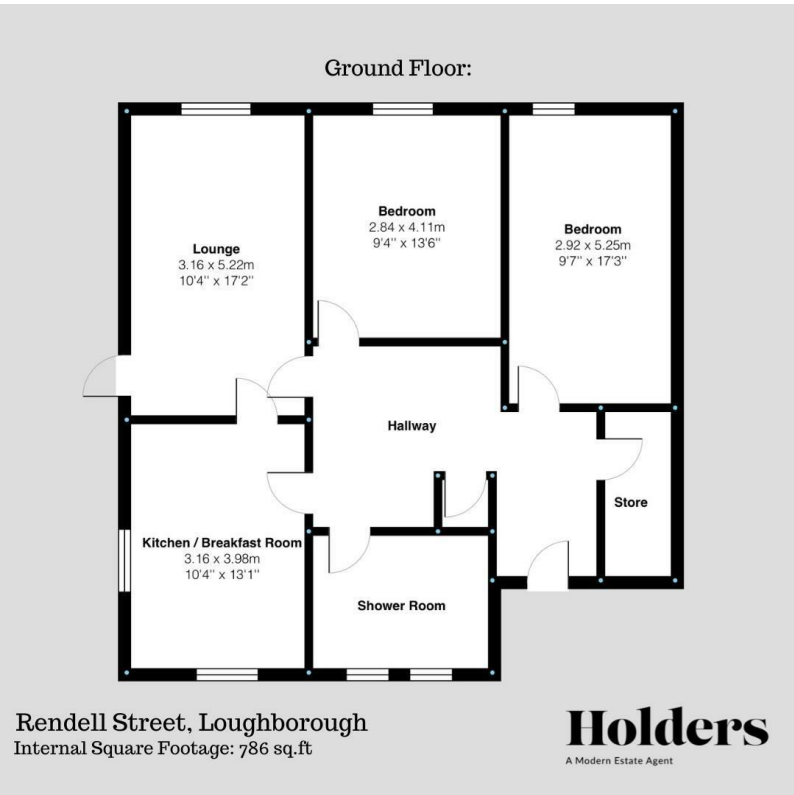

Area Map

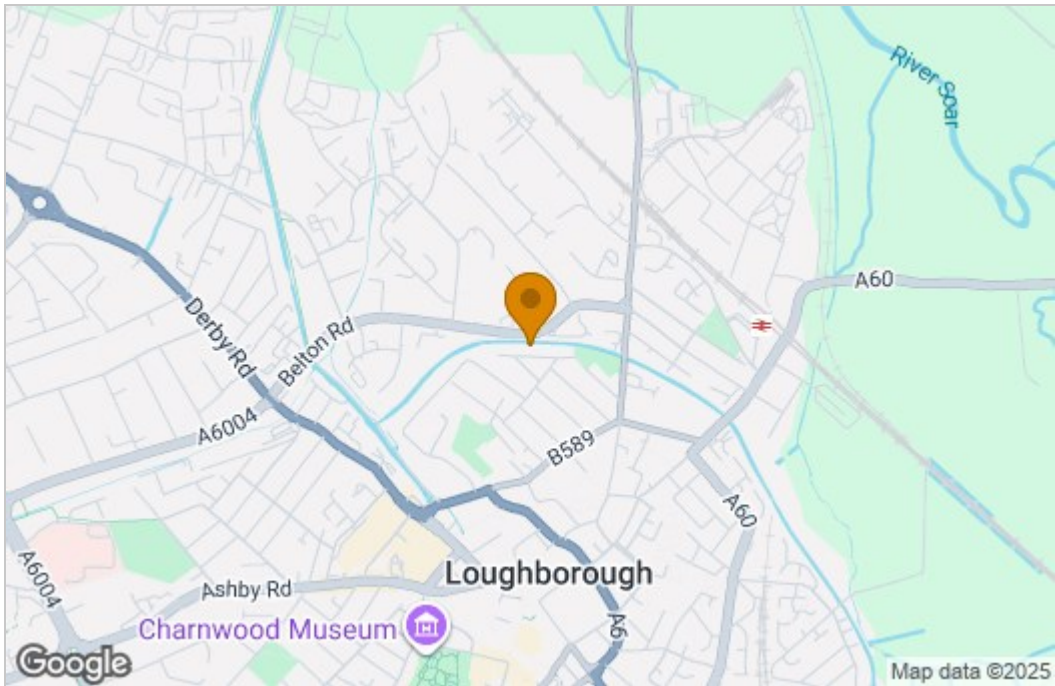

Energy Efficiency Graph

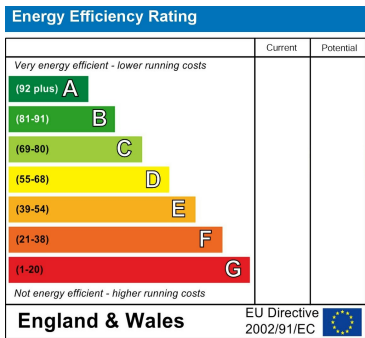

These particulars, whilst believed to be accurate are set out as a general outline only for guidance and do not constitute any part of an offer or contract. Intending purchasers should not rely on them as statements of representation of fact, but must satisfy themselves by inspection or otherwise as to their accuracy. No person in this firms employment has the authority to make or give any representation or warranty in respect of the property.