



Forum Magnum Square | London | SE1 7GL

£520 Per Week

**ICON**  
RESIDENTIAL

Forum Magnum Square |  
 London | SE1 7GL  
 £520 Per Week

Nestled in the vibrant Forum Magnum Square, this modern flat offers a delightful blend of comfort and convenience. Spanning an impressive 485 square feet, the property features a well-appointed reception room that serves as the perfect space for relaxation or entertaining guests. The bedroom is thoughtfully designed to provide a peaceful retreat, ensuring restful nights and rejuvenating mornings.

- Modern flat in prime location
- Bright reception room
- Built in 2000, well-maintained
- Close to transport links
- Compact 485 sq ft space
- Spacious 1-bedroom apartment
- Contemporary bathroom design
- Centrally located in Forum Magnum
- Ideal for singles or couples
- Viewing highly recommended

The flat includes a contemporary bathroom, equipped with modern fixtures that enhance the overall appeal of the home. Built in 2000, this property boasts a fresh and stylish aesthetic, making it an ideal choice for those seeking a contemporary living space.

surrounded by a lively community, with an array of shops, cafes, and amenities just a stone's throw away. This location not only offers convenience but also a vibrant atmosphere that is sure to enrich your daily life.

Living in Forum Magnum Square means you are

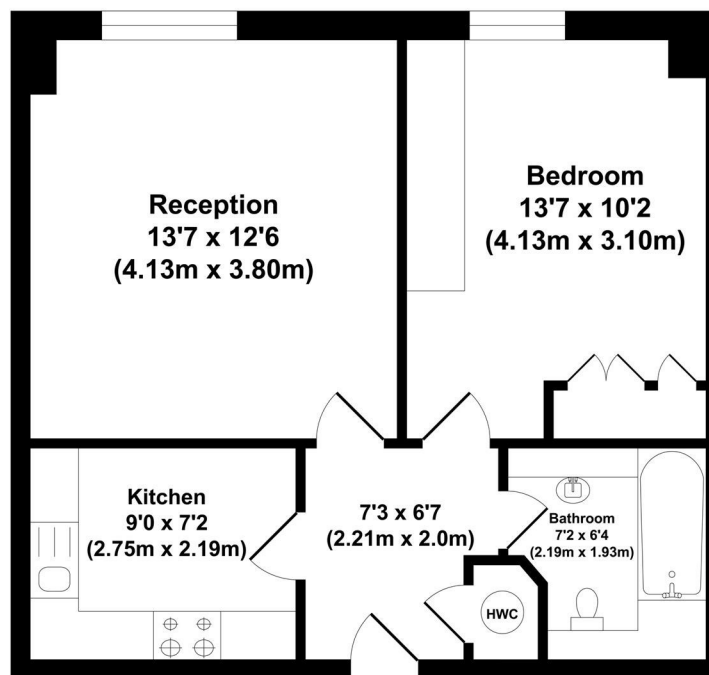

TOTAL APPROX FLOOR AREA 484.48 SQ. FT. (AREA 45.01 SQ. M)

whilst every attempt has been made to ensure the accuracy of the floor plan contained here, measurements of doors, windows, rooms and any other items are approximate and no responsibility is taken for any error, omission or mis-statement. This plan is for illustrative purposes only and should be used as such by any prospective purchaser. The services, systems and appliances shown have not been tested and no guarantee as to their operability or efficiency can be given.

Energy Efficiency Rating		Current	Potential
Very energy efficient - lower running costs			
(92 plus)	A		
(81-91)	B		
(69-80)	C		
(55-68)	D		
(39-54)	E		
(21-38)	F		
(1-20)	G		
Not energy efficient - higher running costs			
England & Wales		75	82
		EU Directive 2002/91/EC	

52 Grosvenor Gardens  
 London  
 SW1W 0AU  
 020 7956 2080  
 steven.hartman@icon-residential.co.uk

<http://www.icon-residential.co.uk/>