



Belmont Mews, Camberley

£350,000

MARTIN & CO

Belmont Mews, Camberley

- Two bedrooms
- Semi detached house
- Garage
- Cul de sac location
- Off street parking
- Central Camberley Location
- No onward chain

A well presented and spacious two bedroom Mews house situated within the heart of Camberley.

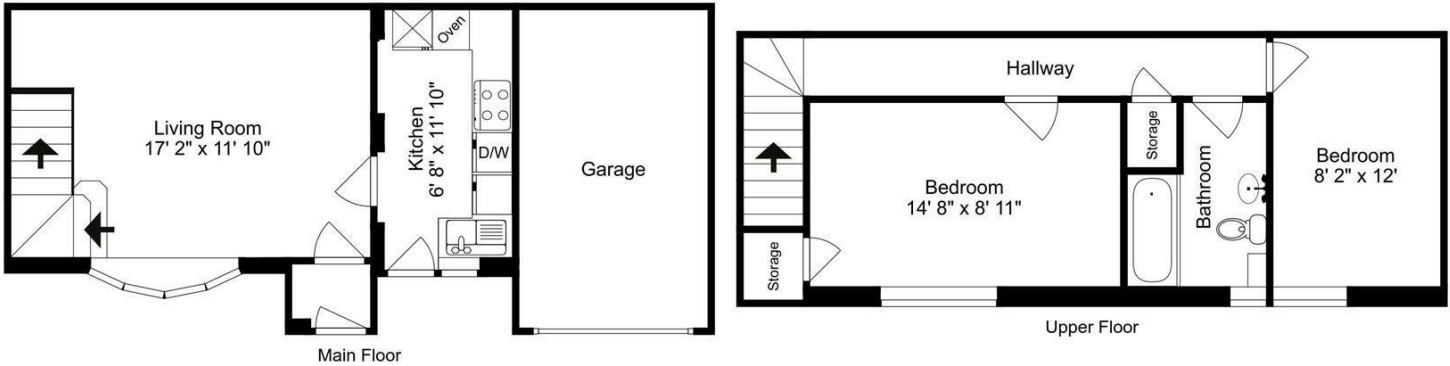

Energy Efficiency Rating	
Current	Potential
Very energy efficient - lower running costs	
(92 plus) A	
(81-91) B	
(69-80) C	
(55-68) D	
(39-54) E	
(21-38) F	
(1-20) G	
Not energy efficient - higher running costs	
58	52
England & Wales	
EU Directive 2002/91/EC	

Environmental Impact (CO ₂) Rating	
Current	Potential
Very environmentally friendly - lower CO ₂ emissions	
(92 plus) A	
(81-91) B	
(69-80) C	
(55-68) D	
(39-54) E	
(21-38) F	
(1-20) G	
Not environmentally friendly - higher CO ₂ emissions	
85	83
England & Wales	
EU Directive 2002/91/EC	

Total Square Footage - 985 sq. ft.

Disclaimer: The floorplans depicted and the stated dimensions in this illustration are indicative only and serve as an approximation of existing structures and features. This illustration is not guaranteed to be accurate or complete. The accuracy of all information should be verified through personal inspection and/or with appropriate professionals.

Martin & Co Aldershot Sales
 173 Victoria Road, Aldershot, Hampshire, GU11 1JU
 01252 311974 . aldershot@martinco.com

01252 311974
<http://www.martinco.com>



Accuracy: References to the Tenure of a Property are based on information supplied by the Seller. The Agent has not had sight of the title documents. A Buyer is advised to obtain verification from their Solicitor. Items shown in photographs including but not limited to carpets, fixtures and fittings are not included unless specifically mentioned within the sales particulars. They may however be available by separate negotiation. Buyers must check the availability of any property and make an appointment to view before embarking on any journey to see a property. No person in the employment of the agent has any authority to make any representation about the property, and accordingly any information given is entirely without responsibility on the part of the agents, sellers(s) or lessors(s). Any property particulars are not an offer or contract, nor form part of one. **Sonic / laser Tape:** Measurements taken using a sonic / laser tape measure may be subject to a small margin of error. **All Measurements:** All Measurements are Approximate. **Services Not tested:** The Agent has not tested any apparatus, equipment, Fixtures and Fittings or services and so cannot verify that they are in working order or fit for the purpose. A Buyer is advised to obtain verification from their Solicitor or Surveyor.

