



Churchdale, Aldershot

£995 PCM

MARTIN&CO

Churchdale, Aldershot

Apartment

1 Bedrooms, 1 Bathroom

£995 PCM

Date Available: 1st May 2026

Deposit: £1,148

Unfurnished

- EPC C71
- Deposit £1,148
- Council Tax Band B
- Modern Kitchen & Bathroom
- Double Bedroom
- Private Residents Carpark
- UPVC Double Glazing
- Close To Train Station
- Short Walk Into Town

Martin & Co are pleased to bring to the market this first floor flat, situated in a popular area of Aldershot which is within walking distance to the Town Centre and Train Station.

Accommodation comprises of a good sized living room, modern kitchen with appliances, double bedroom and modern bathroom.

Further benefits include a private car park for residents and UPVC double glazing.

Available from the 1st May 2026 on an unfurnished basis.

Minimum household income for references required - £29,850

Holding deposit (one weeks rent) - £229

This is a guide only and is subject to a full affordability assessment on application, which includes any other credit commitments and credit history.





Energy Efficiency Rating

	Current	Potential
Very energy efficient - lower running costs (92 plus) A		
(81-91) B		
(69-80) C		
(55-68) D		
(39-54) E		
(21-38) F		
(1-20) G		
Not energy efficient - higher running costs		

71 78

England & Wales EU Directive 2002/91/EC

Environmental Impact (CO₂) Rating

	Current	Potential
Very environmentally friendly - lower CO ₂ emissions (92 plus) A		
(81-91) B		
(69-80) C		
(55-68) D		
(39-54) E		
(21-38) F		
(1-20) G		
Not environmentally friendly - higher CO ₂ emissions		

55 64

England & Wales EU Directive 2002/91/EC

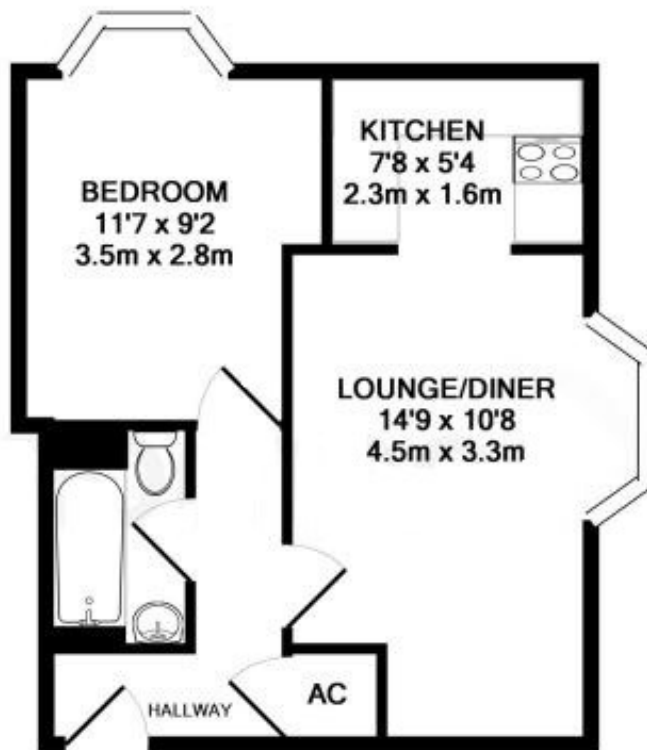

Martin & Co Aldershot Lettings
173 Victoria Road, Aldershot, Hampshire, GU11 1JU
01252 311974 . aldershot@martinco.com

01252 311974
<http://www.martinco.com>



Accuracy: References to the Tenure of a Property are based on information supplied by the Seller. The Agent has not had sight of the title documents. A Buyer is advised to obtain verification from their Solicitor. Items shown in photographs including but not limited to carpets, fixtures and fittings are not included unless specifically mentioned within the sales particulars. They may however be available by separate negotiation. Buyers must check the availability of any property and make an appointment to view before embarking on any journey to see a property. No person in the employment of the agent has any authority to make any representation about the property, and accordingly any information given is entirely without responsibility on the part of the agents, sellers(s) or lessors(s). Any property particulars are not an offer or contract, nor form part of one. **Sonic / laser Tape:** Measurements taken using a sonic / laser tape measure may be subject to a small margin of error. **All**

Measurements: All Measurements are Approximate. **Services Not tested:** The Agent has not tested any apparatus, equipment, Fixtures and Fittings or services and so cannot verify that they are in working order or fit for the purpose. A Buyer is advised to obtain verification from their Solicitor or Surveyor.