



The Peninsula, Pegasus Way

£1,100 PCM

MARTIN&CO

The Peninsula, Pegasus Way

Date Available: 4th November 2025
Deposit: £1,269
Unfurnished

- MODERN STUDIO PLUS APARTMENT
- SPECTACULAR RIVERSIDE VIEW
- POPULAR DEVELOPMENT
- HIGH TECH LIGHTING SYSTEM
- FULL SIZE FRIDGE / FREEZER
- DISHWASHER
- LAUNDRY CUPBOARD WITH WASHING MACHINE
- MODERN BATHROOM WITH DOUBLE SHOWER
- HIGH QUALITY FIXTURES AND FITTINGS
- UNDERGROUND PARKING FOR ONE CAR

Energy Efficiency Rating		Environmental Impact (CO ₂) Rating	
	Current	Potential	
Very energy efficient - lower running costs			Very environmentally friendly - lower CO ₂ emissions
(92 plus) A			(92 plus) A
(81-91) B			(81-91) B
(69-80) C			(69-80) C
(55-68) D			(55-68) D
(39-54) E			(39-54) E
(21-38) F			(21-38) F
(1-20) G			(1-20) G
Not energy efficient - higher running costs			Not environmentally friendly - higher CO ₂ emissions
England & Wales		England & Wales	
EU Directive 2002/91/EC		EU Directive 2002/91/EC	

Nestled in the sought-after development of The Peninsula on Pegasus Way, this exceptionally well-presented studio plus apartment offers a unique blend of modern living and stunning natural beauty. With a spectacular riverside view, this property is perfect for those who appreciate both style and serenity.

Upon entering, you will be greeted by a bright and airy reception room that seamlessly integrates with the sleeping area, creating a spacious and inviting atmosphere. The apartment boasts a high-tech lighting system, allowing you to set the perfect mood for any occasion. The kitchen is equipped with high-quality fixtures and fittings, featuring a full-size fridge/freezer and a dishwasher, making it ideal for both cooking and entertaining.

The modern bathroom is a true highlight, complete with a luxurious double shower that provides a spa-like experience. Additionally, the apartment includes a convenient laundry cupboard fitted with a washing machine, ensuring that all your needs are met within this stylish abode.

This property is not only a comfortable home but also part of a popular development that enhances the living experience with its attractive surroundings. Whether you are a first-time buyer or looking for a rental opportunity, this studio plus apartment is a remarkable choice that combines contemporary design with practical amenities. Don't miss the chance to make this riverside

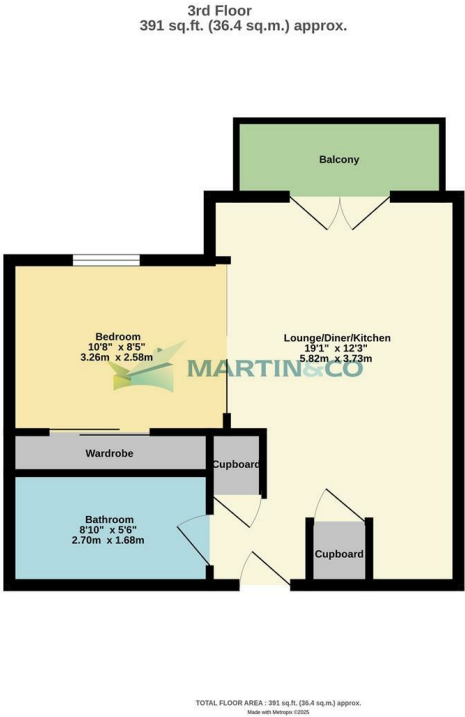

Martin & Co Medway Lettings
161 High Street, Rochester, Kent, ME1 1EH
01634 838700 . medway@martinco.com

01634 838700
<http://www.martinco.com>



Accuracy: References to the Tenure of a Property are based on information supplied by the Seller. The Agent has not had sight of the title documents. A Buyer is advised to obtain verification from their Solicitor. Items shown in photographs including but not limited to carpets, fixtures and fittings are not included unless specifically mentioned within the sales particulars. They may however be available by separate negotiation. Buyers must check the availability of any property and make an appointment to view before embarking on any journey to see a property. No person in the employment of the agent has any authority to make any representation about the property, and accordingly any information given is entirely without responsibility on the part of the agents, sellers(s) or lessors(s). Any property particulars are not an offer or contract, nor form part of one. **Sonic / laser Tape:** Measurements taken using a sonic / laser tape measure may be subject to a small margin of error. **All Measurements:** All Measurements are Approximate. **Services Not tested:** The Agent has not tested any apparatus, equipment, Fixtures and Fittings or services and so cannot verify that they are in working order or fit for the purpose. A Buyer is advised to obtain verification from their Solicitor or Surveyor.

