



High Street, Chatham, Kent

£900 PCM

MARTIN&CO

High Street, Chatham, Kent

Date Available: 14th July 2025

Deposit: £1,038

Unfurnished

Council Tax Band: A

- URBAN LOCATION
- GOOD SIZE RECEPTION ROOM
- NATURAL LIGHT-FILLED
- DOUBLE AND SINGLE BEDROOM
- WELL APPOINTED KITCHEN
- BATHROOM WITH SHOWER CUBICLE
- EXCELLENT TRANSPORT LINKS
- NEARBY LOCAL AMENITIES
- NO DEPOSIT OPTION AVAILABLE
- AVAILABLE JULY 2025

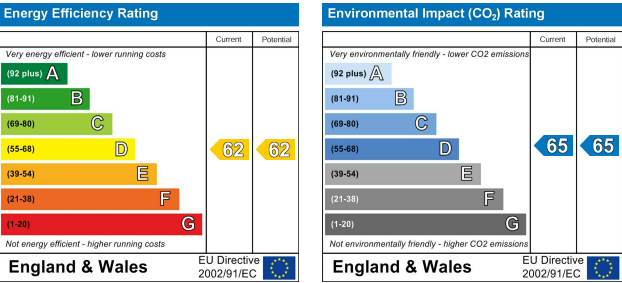

A splendid two-bedroom flat in a vibrant urban location, offering a spacious open-plan reception room, a well-equipped kitchen, and a bathroom, perfect for individuals or single occupancy seeking comfort, convenience, and excellent transport links.

NO DEPOSIT OPTION AVAILABLE

AVAILABLE JULY 2025

If you would like to arrange a viewing for this property, please submit an online enquiry to us via this website using the 'email agent' or 'request data' buttons.

Mid Floor
489 sq.ft. (45.4 sq.m.) approx.

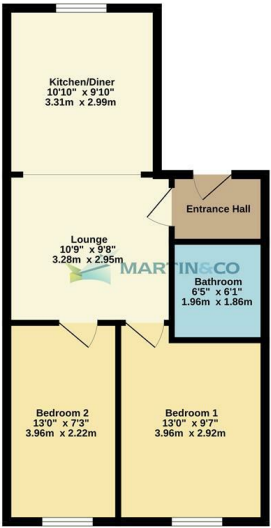

TOTAL FLOOR AREA - 489 sq.ft. (45.4 sq.m.) approx.
Made with Metaplan 10025

Martin & Co Medway Lettings
161 High Street, Rochester, Kent, ME1 1EH
01634 838700 . medway@martinco.com

01634 838700
<http://www.martinco.com>



Accuracy: References to the Tenure of a Property are based on information supplied by the Seller. The Agent has not had sight of the title documents. A Buyer is advised to obtain verification from their Solicitor. Items shown in photographs including but not limited to carpets, fixtures and fittings are not included unless specifically mentioned within the sales particulars. They may however be available by separate negotiation. Buyers must check the availability of any property and make an appointment to view before embarking on any journey to see a property. No person in the employment of the agent has any authority to make any representation about the property, and accordingly any information given is entirely without responsibility on the part of the agents, sellers(s) or lessors(s). Any property particulars are not an offer or contract, nor form part of one. **Sonic / laser Tape:** Measurements taken using a sonic / laser tape measure may be subject to a small margin of error. **All Measurements:** All Measurements are Approximate. **Services Not tested:** The Agent has not tested any apparatus, equipment, Fixtures and Fittings or services and so cannot verify that they are in working order or fit for the purpose. A Buyer is advised to obtain verification from their Solicitor or Surveyor.

