



**Monson Mews, Monson Street,
Lincoln**

£250 Per Month

MARTIN & CO

Monson Mews, Monson Street,
Lincoln

Apartment
2 Bedrooms, 2 Bathroom

£850 Per Month

Date Available: 24th November
2025

Deposit: £600

- Two Bedroom Top Floor Apartment
- Four Piece Bathroom
- Walking Distance to City Centre
- Allocated Parking
- Secure Intercom Entry
- GCH & PVC DG
- EPC - B
- Lincoln City Council - A

Two Bedroom Top Floor Apartment ideally situated off the High Street. Comprising; open plan living with fitted kitchen with washing machine/dryer and integrated fridge with freezer box. Large double bedroom and 2nd double bedroom, four piece bathroom including walk in shower and allocated parking for one vehicle.



Description
 Two Bedroom Top Floor Apartment ideally situated off the High Street. Comprising; open plan living with fitted kitchen with washing machine/dryer and integrated fridge with freezer box. Large double bedroom and 2nd double bedroom, four piece bathroom including walk in shower and allocated parking for one vehicle.

Unfortunately we are unable to accept pets or smokers on this property

EPC - B
 Lincoln City Council - A
 Initial 12 Month Tenancy

Mobile (based on calls indoors)
 O2 EE Three Vodafone

Broadband (estimated speeds)
 Standard 12 mbps
 Superfast 74 mbps
 Ultrafast 1800 mbps

Satellite & Cable TV Availability
 BT Sky



Energy Efficiency Rating		Current	Potential
Very energy efficient - lower running costs			
(92 plus) A			
(81-91) B			
(69-80) C			
(55-68) D			
(39-54) E			
(21-38) F			
(1-20) G			
Not energy efficient - higher running costs			
England & Wales		81	81
	EU Directive 2002/91/EC		

Environmental Impact (CO ₂) Rating		Current	Potential
Very environmentally friendly - lower CO ₂ emissions			
(92 plus) A			
(81-91) B			
(69-80) C			
(55-68) D			
(39-54) E			
(21-38) F			
(1-20) G			
Not environmentally friendly - higher CO ₂ emissions			
England & Wales		85	85
	EU Directive 2002/91/EC		

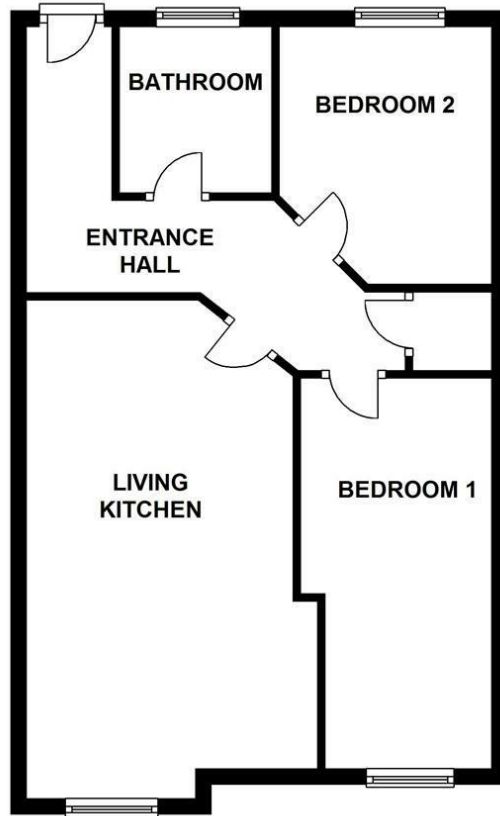

The marketing plans shown are for guidance purposes only and are not to be relied upon for scale or accuracy.
Plan produced using The Mobile Agent.

Martin & Co Lincoln Lettings
33 The Forum, North Hykeham, Lincoln, Lincolnshire, LN6
8HW
01522 503727 . lincoln@martinco.com

01522 503727
<http://www.martinco.com>



Accuracy: References to the Tenure of a Property are based on information supplied by the Seller. The Agent has not had sight of the title documents. A Buyer is advised to obtain verification from their Solicitor. Items shown in photographs including but not limited to carpets, fixtures and fittings are not included unless specifically mentioned within the sales particulars. They may however be available by separate negotiation. Buyers must check the availability of any property and make an appointment to view before embarking on any journey to see a property. No person in the employment of the agent has any authority to make any representation about the property, and accordingly any information given is entirely without responsibility on the part of the agents, sellers(s) or lessors(s). Any property particulars are not an offer or contract, nor form part of one. **Sonic / Laser Tape:** Measurements taken using a sonic / laser tape measure may be subject to a small margin of error. **All**

Measurements: All Measurements are Approximate. **Services Not tested:** The Agent has not tested any apparatus, equipment, Fixtures and Fittings or services and so cannot verify that they are in working order or fit for the purpose. A Buyer is advised to obtain verification from their Solicitor or Surveyor.

