



Omar Ikon 50 x 20 Long Carrant Views, Ashton-Under-Hill, Evesham,
Worcestershire, WR11 7QP

£324,950

 **GOODCHILD**
ESTATE AGENTS

goodchild.co.uk



Omar Ikon 50 x 20 Long Carrant Views, Ashton-Under-Hill, Evesham, Worcestershire. WR11 7QP

£324,950

PROPERTY OVERVIEW

Coming soon is a popular model in the Omar park home portfolio, the Ikon is dressed to impress, with immediate kerb appeal, contemporary styling and a great deal of luxury throughout. 50 x 20 sq ft.

Externally, long slender windows and French doors (to the lounge) let light flood in. Together with the feature cladding detail and a central dormer framing a feature front door, these all come together to create a modern, classy look. The layout, which includes a central kitchen / diner with a lounge separated by double doors, provides the option to open up the living space or to have separate rooms. That also makes the living spaces great for entertaining and get-togethers with family or friends.

Both bedrooms feel like master bedrooms, enjoying plenty of built-in storage space behind mirrored, sliding doors. With botanical styling in the soft furnishings and contemporary accents throughout, this home is designed to be enjoyed.

PLEASE NOTE THE IMAGE DISPLAYED IS FOR ILLUSTRATIVE PURPOSES ONLY AND IS NOT THE ACTUAL MODEL.

Location

Ashton-Under-Hill is a quaint, charming village nestled in the Cotswold foothills, just a short drive from Evesham, Worcestershire. With scenic roads connecting you to essential amenities in Evesham (about 15 minutes away), residents enjoy the perfect balance of peaceful village life with the convenience of nearby shops, healthcare, and leisure options.

With its stunning Cotswold backdrop, Ashton-Under-Hill boasts rolling hills, open meadows, and beautiful seasonal landscapes. The area is ideal for leisurely walks, nature watching, and peaceful moments of reflection, all just steps from your door. For those who relish outdoor activities or simply enjoy a peaceful environment, this location offers the ideal countryside retreat, enhancing your lifestyle with natural beauty at every turn.

IMPORTANT NOTICE: These park homes are marketed jointly by Goodchild Estate Agents? and Highgrove Parks Ltd. Goodchild Estate Agents act as marketing agents only. Viewings, negotiations and receipt of any monies are handled solely by Highgrove Parks Ltd. Buyers should satisfy themselves regarding site rules, pitch fees, tenure/licence arrangements and all other matters relating to the park and home.

0117 454 7054 | hello@goodchild.co.uk | goodchild.co.uk

KEY DETAILS

- 2 Bedrooms
- 2 Bathrooms
- Fully Furnished
- All Integrated Appliances
- Vaulted Ceilings Throughout
- Large Decking With Glass Screening

Guide Price: £324,950

Tenure: N/A

Council Tax Band: A

Local Authority: Worcestershire

Vendors Onward Position:

No Onward Chain

EPC: N/A

Viewing: By appointment only



Omar Ikon 50 x 20 Long Carrant Views, Ashton-Under-Hill, Evesham, Worcestershire. WR11 7QP
£324,950

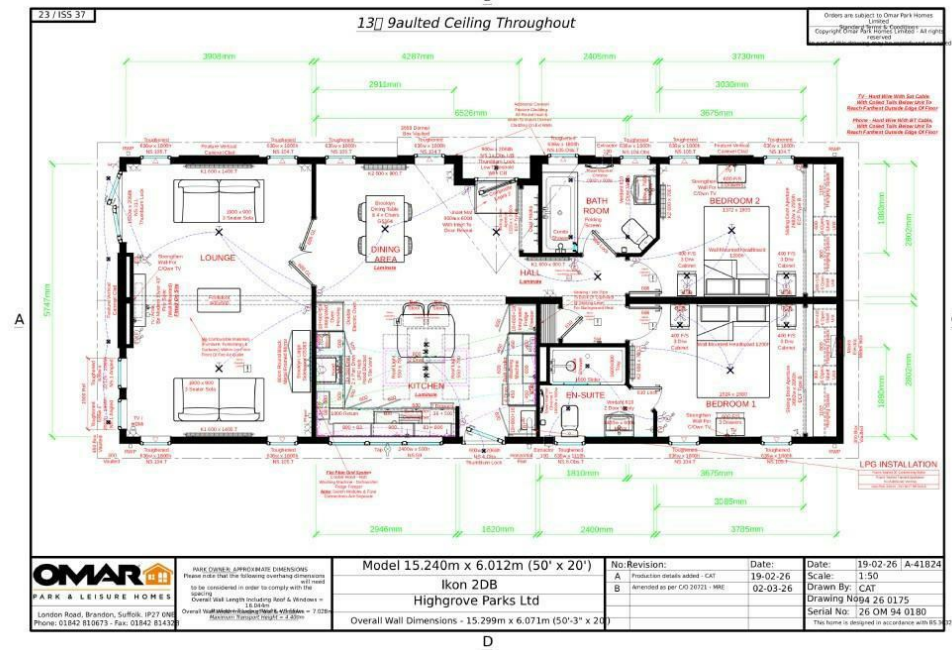

0117 454 7054 | hello@goodchild.co.uk | goodchild.co.uk

Important Notice:

These particulars are set out as a general outline only for the guidance of intended purchasers or lessees, and do not constitute, any part of a contract.

Nothing in these particulars shall be deemed to be a statement that the property is in good structural condition or otherwise nor that any of the services, appliances, equipment or facilities are in good working order and have not been checked nor tested. Please note that any site or floor plans are for illustrative purposes only and may not be to scale and any photographs may have been taken with a wide angle lens. Any distance from schools are for guidance only and you should make your own enquiries with the local authority. Purchasers should satisfy themselves of this prior to purchasing.

If you would like a valuation please either call, email or follow the QR to book online.



0117 454 7054

hello@goodchild.co.uk

goodchild.co.uk

