

Adriatic Apartments, E16 1BU

Approx Gross Internal Area = 39 sq m / 420 sq ft

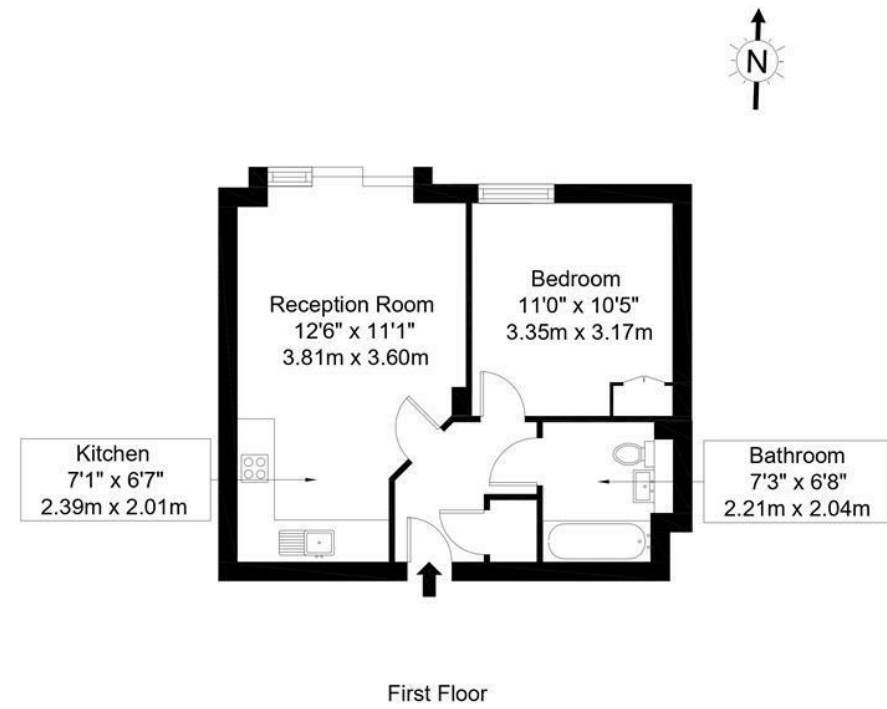

Ref

Copyright **BLEU PLAN**

The Floor plan is not to scale and measurements and areas shown are approximate and therefore should be used for illustrative purposes only. The plan has been prepared in accordance with the RICS code of Measuring Practice and whilst we have confidence in the information produced it must not be relied on. If there is any aspect of particular importance, you should carry out or commission your own inspection of the property.
Copyright @ BLEUPLAN

Council Tax Band

C

Energy Performance Graph

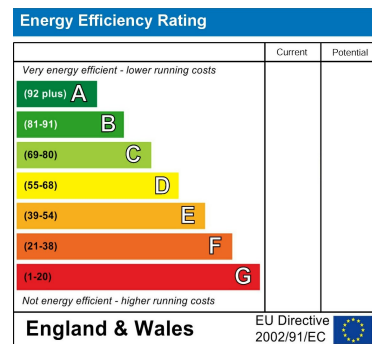

Call us on

02078460308

info@stonebanks.co.uk

www.stonebanks.co.uk

Agents Note: Whilst every care has been taken to prepare these particulars, they are for guidance purposes only. All measurements are approximate and are for general guidance purposes only and whilst every care has been taken to ensure their accuracy, they should not be relied upon and potential buyers are advised to recheck the measurements.



LEASEHOLDNULL



APARTMENT (EPC RATING:)

20 ADRIATIC APARTMENTS, WESTERN GATEWAY, LONDON, E16 1BU OFFERS OVER

£279,999



1 Bedroom Apartment located in London

1 Bed Apartment with Large Terrace | Adriatic Apartments, Western Gateway, E16

Key Features:

- * Spacious 1 Bedroom, 1 Bathroom Apartment
- * Generous Private Terrace – Perfect for Outdoor Dining
- * Stylish Open-Plan Kitchen & Living Area
- * 132 Years Remaining on Lease
- * Ground Rent: 200 per annum
- * Service Charge: Approx. 4,000 per annum
- * Currently Let at 2,100 pcm – Strong Rental Yield
- * Excellent Transport Links – Royal Victoria DLR Nearby
- * Moments from the Royal Docks & Waterfront



Stonebanks | 22a Northfield Avenue, Ealing, London, W13 9RL

Stonebanks | 22a Northfield Avenue, Ealing, London, W13 9RL