

8 Park Lawn
Farnham Royal
SL2 3AP





8 Park Lawn

£1,750 Per Month

Huntmore Homes are delighted to offer for letting this one bedroom second floor Period Mansion Apartment with garage and being set in a gated development set acres of manicured grounds overlooking Stoke Park Golf Course.

Accommodation comprises communal entrance hall, inner hall, lounge, separate kitchen, bedroom, bathroom, gas central heating, garage, gated with sweeping driveway and extensive communal grounds.

The rental is inclusive of the heating and hot water bills for the property.

Call now to book a viewing.

Local Authority
South Buckinghamshire

Council Tax Band
D

Directions

Energy Efficiency Rating		
	Current	Potential
Very energy efficient - lower running costs		
(92 plus) A		
(81-91) B		
(69-80) C		
(55-68) D	64	
(39-54) E		
(21-38) F		
(1-20) G		
Not energy efficient - higher running costs		

England & Wales EU Directive 2002/91/EC



Agents Note: Whilst every care has been taken to prepare these particulars, they are for guidance purposes only. All measurements are approximate and are for general guidance purposes only and whilst every care has been taken to ensure their accuracy, they should not be relied upon and potential buyers/tenants are advised to recheck the measurements

Park Lawn

Approximate Gross Internal Floor Area = 59.1 sq m / 637 sq ft

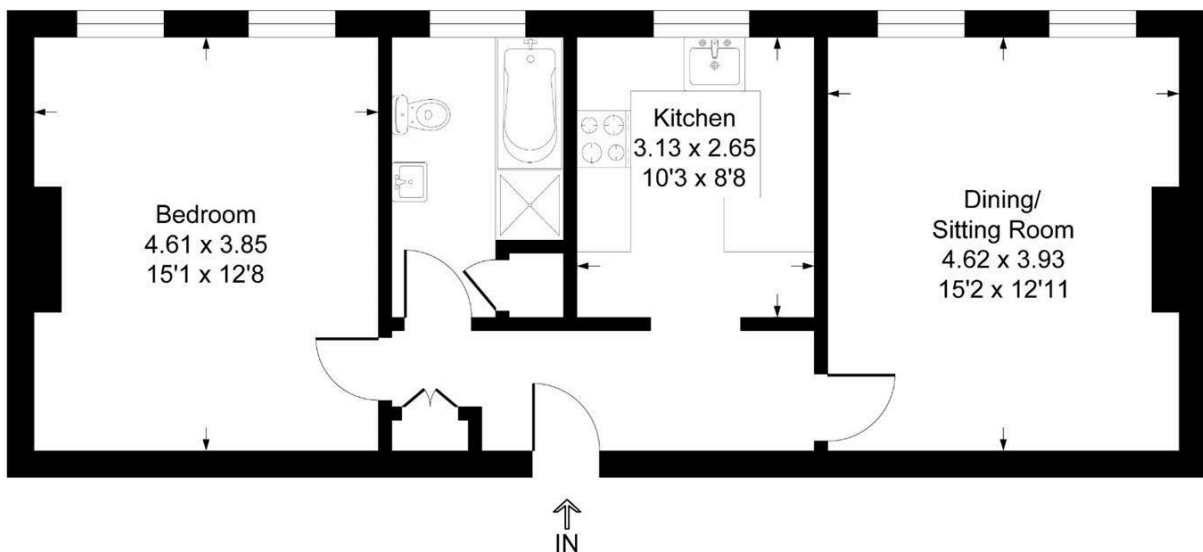

Illustration for identification purposes only, measurements are approximate, not to scale.



Ealing

38 St Mary's Road

Ealing

W5 5EU

Contact

020 8567 2648

ealing@huntmorehomes.com

www.huntmorehomes.com

HUNTMORE
— HOMES —