



## Woodsage Drive , Gillingham SP8 4UE

Nestled in the charming area of Woodsage Drive, Gillingham, this delightful two-bedroom house presents an excellent opportunity for both first-time buyers and those seeking a comfortable rental. The property boasts a well-proportioned reception room, perfect for entertaining guests or enjoying quiet evenings at home.

The two bedrooms offer ample space, making them ideal for a small family, a couple, or even as a home office. The bathroom is conveniently located, ensuring ease of access for all residents.

This house is situated in a friendly neighbourhood, providing a sense of community while still being close to local amenities, schools, and parks. The surrounding area is well-connected, making commuting to nearby towns and cities straightforward.

With its inviting atmosphere and practical layout, this property is a wonderful place to call home. Whether you are looking to settle down or invest, this house on Woodsage Drive is certainly worth considering.

## £220,000 Freehold



Local Authority  
Council Tax Band **B**  
EPC Rating **C**

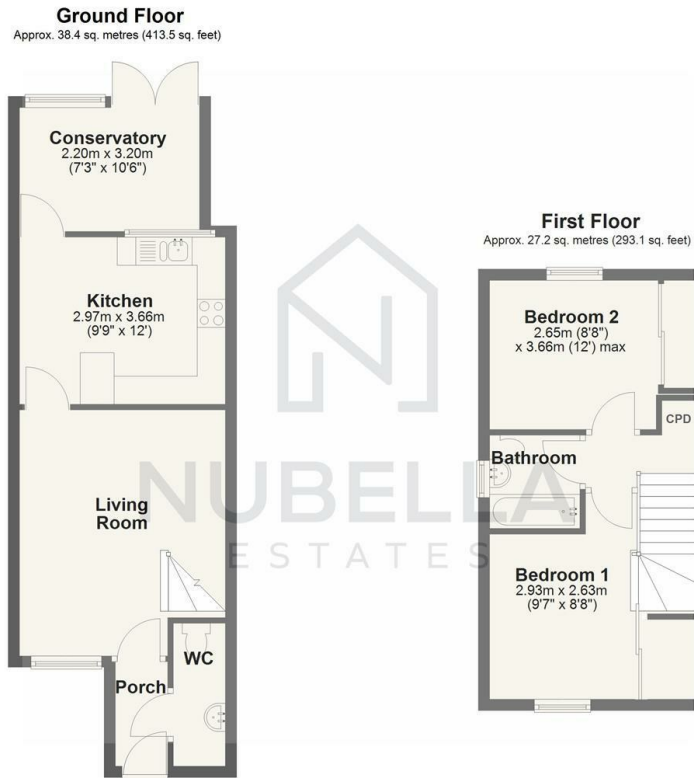

Total area: approx. 65.6 sq. metres (706.6 sq. feet)

**Gillingham Office**  
The Old School Room Newbury,  
Gillingham, SP8 4QJ

**Contact**  
01747 440880  
sales@nubellaestates.com  
www.nubellaestates.com

Agents Note: Whilst every care has been taken to prepare these particulars, they are for guidance purposes only. All measurements are approximate and for general guidance purposes only and whilst every care has been taken to ensure accuracy, they should not be relied upon and potential buyers/tenants are advised to recheck the measurements.

