

61A Bettsworth Road, Ryde, PO33 3EN

Asking Price £279,995

EPC Rating: Council Tax Band:

**ELLIOTT  
LINCOLN**  
ESTATE AGENTS & ASSOCIATES

*Reassuringly familiar, refreshingly new*



Brand-new Passive, EPC A-rated three-bedroom, 1.5 bathroom semi-detached home in Ryde, enjoying a private garden and attractive rural views.

**ELLIOTT  
LINCOLN**  
ESTATE AGENTS & ASSOCIATES

*Reassuringly familiar, refreshingly new*

Call or WhatsApp: 01983 642622  
office@elliottlincoln.co.uk  
www.elliottlincoln.co.uk

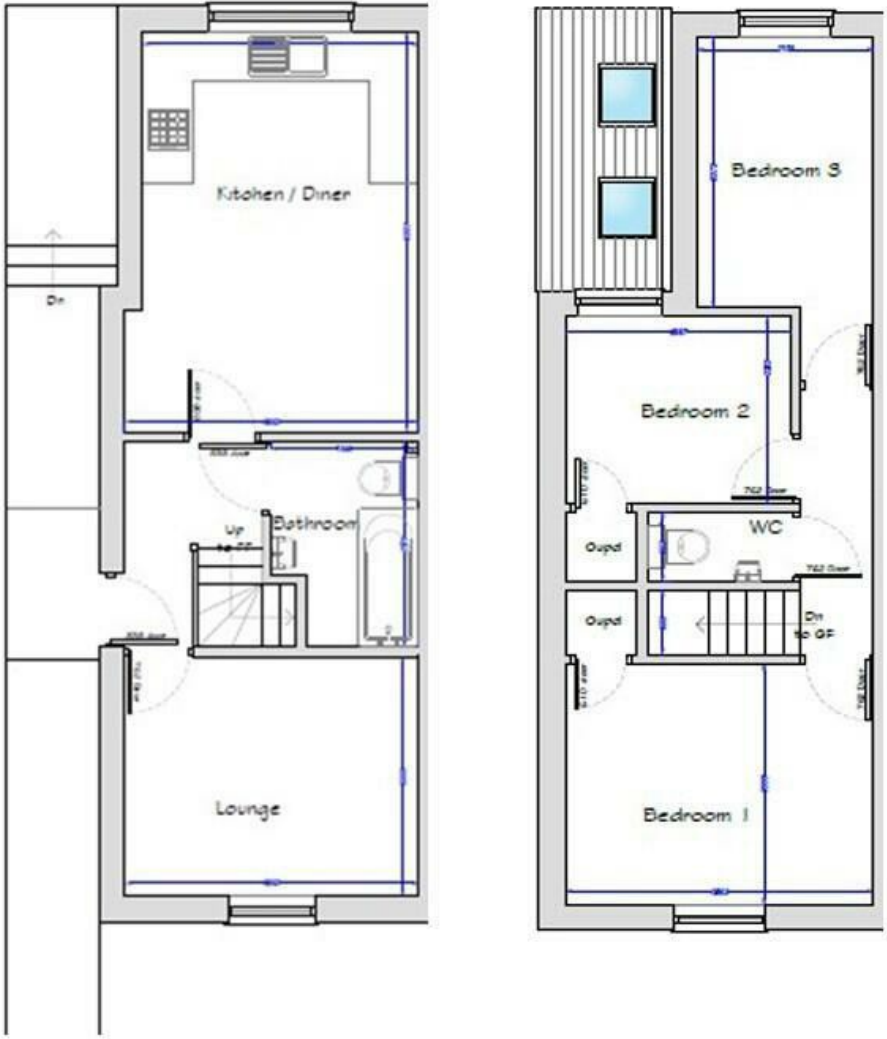

Energy Efficiency Rating		Current	Potential
<i>Very energy efficient - lower running costs</i>			
(92 plus) <b>A</b>			
(81-91) <b>B</b>			
(69-80) <b>C</b>			
(55-68) <b>D</b>			
(39-54) <b>E</b>			
(21-38) <b>F</b>			
(1-20) <b>G</b>			
<i>Not energy efficient - higher running costs</i>			
<b>England &amp; Wales</b>	EU Directive 2002/91/EC		