



Bush & Co.

61 Parkside Place, Cambridge - £2,700 PCM

A wonderfully spacious and highly specified modern third floor, two double bedroom furnished apartment just minutes from Parkers Piece, located within walking distance of the City Centre and mainline Train Station. The property benefits from having an allocated under croft parking space, bike park and concierge.

Communal Entrance

Secure communal entrance with stairs and lift access leading to third floor apartment

Entrance Hallway

Spacious entrance hallway with cupboard housing washer-drier (2.12 x 1.50m)

Living Room

15'1" x 11'1" (4.60 x 3.40)
Large open plan living room with wooden floors and fully fitted kitchen area with electric hob and oven, dishwasher and fridge freezer

Bedroom 1

15'1" x 9'4" (4.60 x 2.86)
Master bedroom with fitted wardrobes and ensuite shower room

Bedroom 2

15'1" x 9'3" (4.60 x 2.82)
Second double bedroom with fitted wardrobes

IMPORTANT NOTICE

These particulars, whilst believed to be accurate are set out as a general outline only for guidance and do not constitute any part of an offer or contract. Intending tenants should not rely on them as statements of representation of fact, but must satisfy themselves by inspection or otherwise as to their accuracy. No person in this firms employment has the authority to make or give any representation or warranty in respect of the property.

Bathroom

Fully tiled bathroom with shower over bath

Key Information

EPC Rating – B
Council Tax Band – E (Cambridge City Council)
Rent – £2700 pcm (£623 pw)
Deposit – £3115
Available furnished 27th September 2025
Long term tenancy
Internet Included in rent

- Third Floor Furnished Apartment
- Two Bathrooms
- Lift & Concierge
- 71.8 sqm / 773 sqft
- Central Location
- Two Double Bedrooms
- Underfloor Heating & Double Glazed
- Under Croft Allocated Parking & Bike Park
- Sorry, No Pets or Smokers
- Large Open Plan Living Room/Kitchen



61, Parkside Place, Parkside, Cambridge, CB1 1HS

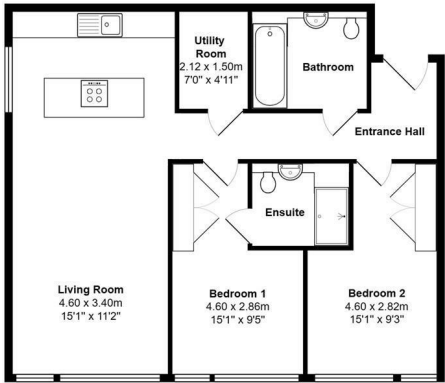

Total Area: 71.8 m² ... 773 ft²
All measurements are approximate and for display purposes only
Plan prepared by charlesjarrison.co.uk

