



PCM

£1,695 PCM  
Melton Road

Leamington Spa, CV32 7DL



## PROPERTY SUMMARY

A well presented four bedroom semi detached property in a popular residential area of Leamington Spa and in the catchment area for North Leamington School. This property has been finished to a great standard throughout and comprises a lounge, dinning room, modern kitchen, large conservatory and W/C. Upstairs there are three double bedrooms , a further single bedroom and a modern family bathroom. The property also benefits from a large garden , driveway aswell as a garage. Unfurnished and Available 18th August 2025

4



1



2







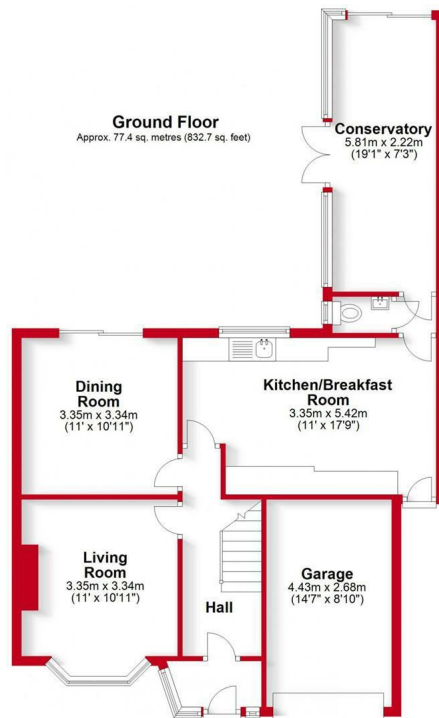

Total area: approx. 124.0 sq. metres (1335.0 sq. feet)

This plan is for illustration purposes only and should not be relied upon as a statement of fact

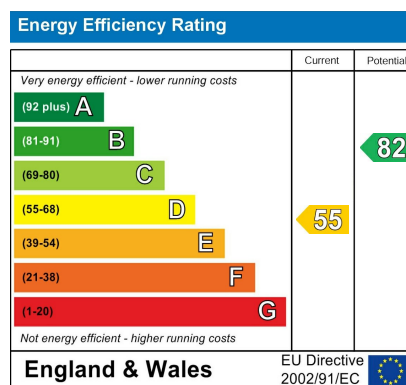
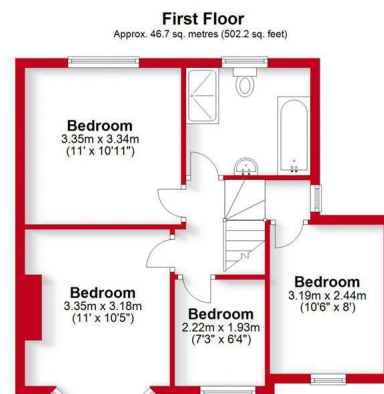

Agents Note: Whilst every care has been taken to prepare these particulars, they are for guidance purposes only. All measurements are approximate and are for general guidance purposes only and whilst every care has been taken to ensure their accuracy, they should not be relied upon and potential buyers/tenants are advised to recheck the measurements



**OFFICE ADDRESS**  
8a Regent Street  
Leamington Spa  
Warwickshire  
CV32 5HO

**OFFICE DETAILS**  
01926 354 400  
leamington@handlesproperty.co.uk