



OFFERS OVER
£225,000

The Spinney

Southam, CV47 2PZ

PROPERTY SUMMARY

The Spinney, Bishops Itchington

This modern two bedroom starter home enjoys a tucked away no-through road location just a short stroll from the village centre.

Bishops Itchington is a charming Warwickshire village known for its rich history, strong community spirit, and beautiful countryside. It offers local amenities like shops, pubs, and community events, along with outdoor attractions such as Bishops Bowl Lakes and nature reserves. The village is well-connected to nearby attractions like the British Motor Museum and Warwick Castle, making it a great place to live or visit.

The village also has a vibrant community with essential amenities, including shops, a post office, a doctors surgery, and a fish and

2



1



1







Ground Floor

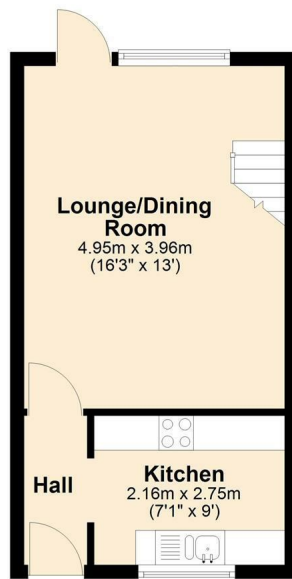

First Floor

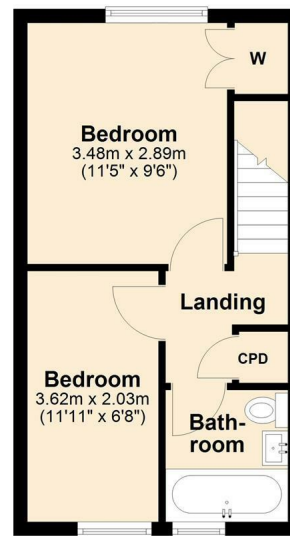

Total area: approx. 55.2 sq. metres (594.5 sq. feet)

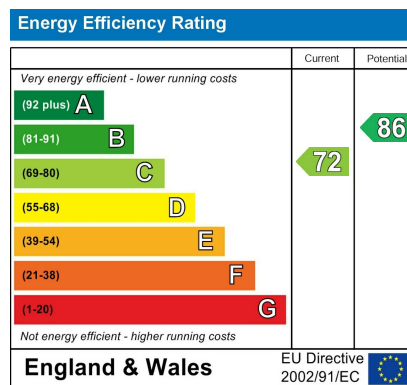
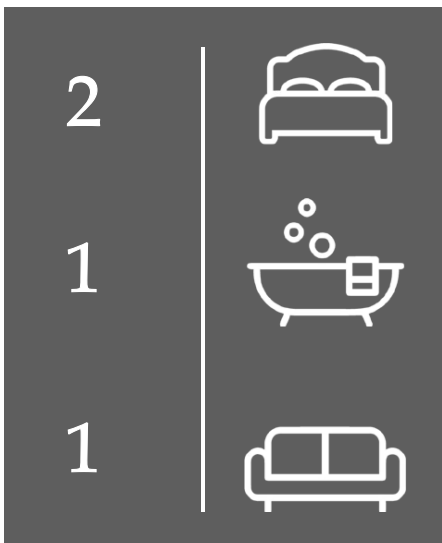

Agents Note: Whilst every care has been taken to prepare these particulars, they are for guidance purposes only. All measurements are approximate and are for general guidance purposes only and whilst every care has been taken to ensure their accuracy, they should not be relied upon and potential buyers/tenants are advised to recheck the measurements



OFFICE ADDRESS
8a Regent Street
Leamington Spa
Warwickshire
CV32 5HO

OFFICE DETAILS
01926 354 400
leamington@handlesproperty.co.uk