



Apartment (EPC Rating:)

**60 DYER STREET, CIRENCESTER,
GLOUCESTERSHIRE, GL7 2PF**
PCM

£1,200 PCM

CANNON ESTATES
SALES & LETTINGS



2 Bedroom Apartment located in Cirencester

Cannon Estates is pleased to present this charming converted Grade II listed apartment, ideally situated in the heart of Cirencester. This delightful first-floor residence boasts two spacious double bedrooms, making it perfect for couples, small families, or those seeking a comfortable home in a vibrant town.

The apartment features a well-proportioned open plan kitchen/living room, providing a welcoming space for relaxation and entertaining. The property also includes a modern bathroom, ensuring convenience and comfort for its residents.

Living in the center of Cirencester means you will have easy access to a variety of local amenities, including shops, cafes, and restaurants, all within a short stroll. The town is known for its rich history and beautiful architecture, offering a unique blend of modern living and traditional charm.

This property is an excellent opportunity for anyone looking to enjoy the benefits of town center living in a historic setting. We invite you to call us now to arrange a viewing and experience the appeal of this lovely apartment for yourself.



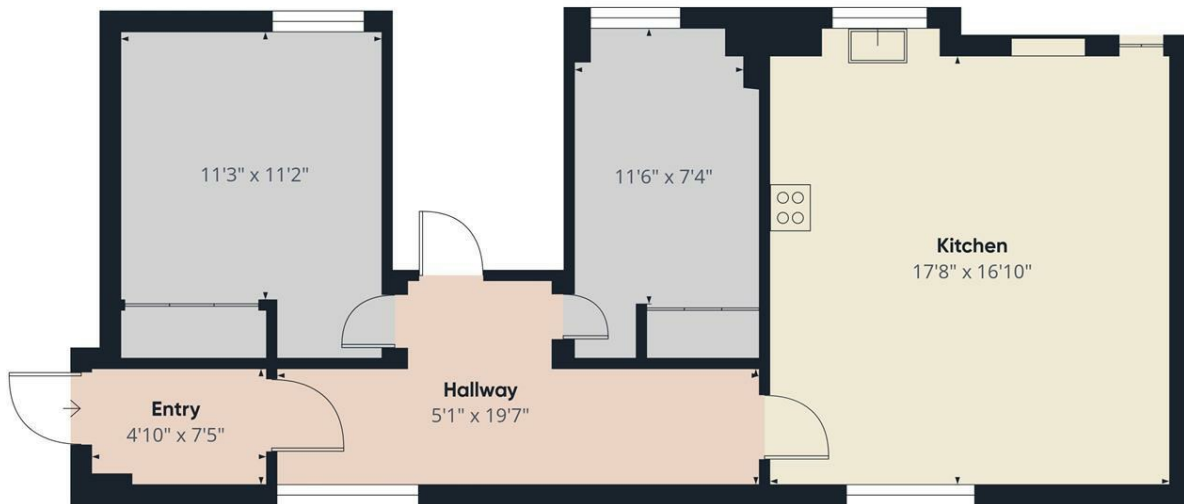

Approximate total area^m
741 ft²

(1) Excluding balconies and terraces

Calculations reference the RICS IPMS 3C standard. Measurements are approximate and not to scale. This floor plan is intended for illustration only.

GIRAFFE360

Council Tax Band

B

Energy Performance Graph

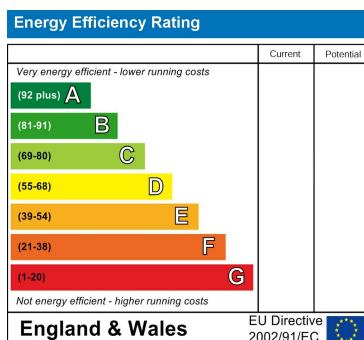

Call us on

01285 706900

info@cannon-estates.co.uk

<https://www.cannon-estates.co.uk/>

Agents Note: Whilst every care has been taken to prepare these particulars, they are for guidance purposes only. All measurements are approximate and are for general guidance purposes only and whilst every care has been taken to ensure their accuracy, they should not be relied upon and potential buyers are advised to recheck the measurements.

CANNON ESTATES
SALES & LETTINGS