



House - Mid Terrace (EPC Rating: C)

**GARDEN CLOSE, CIRENCESTER,
GLOUCESTERSHIRE, GL7 1UW**
PCM

£1,400 PCM

CANNON ESTATES
SALES & LETTINGS



3



1



2



C

3 Bedroom House - Mid Terrace located in Cirencester

A short stroll from the centre of Cirencester, this recently refurbished three-bedroom home offers the perfect blend of modern comfort and timeless style. Tucked away in a peaceful residential area, the property enjoys both a quiet Cul-de-sac setting and easy access to the towns' excellent amenities.

Upon entering, you are welcomed into a bright and airy interior that has been thoughtfully updated to compliment the fresh and contemporary living space. The ground floor features a spacious open plan sitting and dining room enhanced by an attractive bay window at the front of the house, combined with a rear window overlooking the courtyard garden. Together they flood the area with natural light through out the day. The room is freshly decorated in tasteful, neutral colours that continue through out the home.

The kitchen is well thought out with attractive cabinetry and a full range of integrated appliances. Sunny and welcoming it leads out onto to a charming, south facing, private courtyard garden.

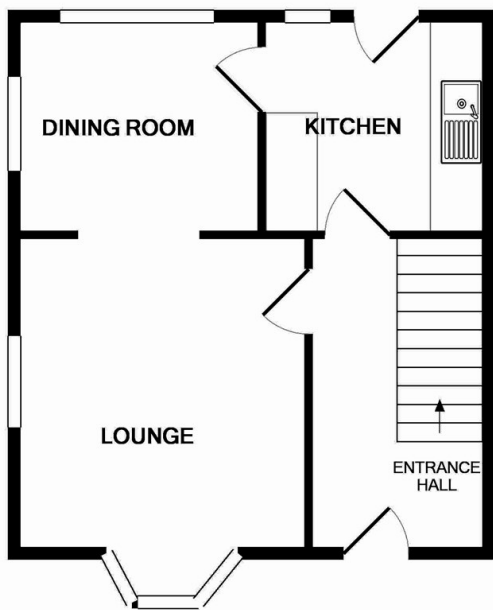

GROUND FLOOR

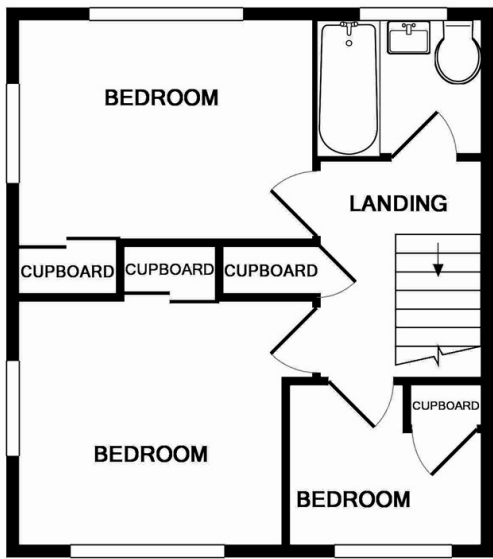

1ST FLOOR

Measurements are approximate. Not to scale. Illustrative purposes only
Made with Metropix ©2018

Council Tax Band
C
Energy Performance Graph

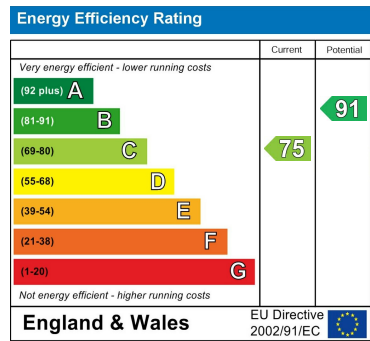

Call us on
01285 706900
info@cannon-estates.co.uk
<https://www.cannon-estates.co.uk/>

Agents Note: Whilst every care has been taken to prepare these particulars, they are for guidance purposes only. All measurements are approximate and are for general guidance purposes only and whilst every care has been taken to ensure their accuracy, they should not be relied upon and potential buyers are advised to recheck the measurements.