



# 1 Bedroom Apartment in Central Tetbury

£885 PCM

Flat 3, Peter Herve  
House  
Eccles Court  
Tetbury  
GL8 8EH



**Victoria Allman**  
lettings

- Ground floor one bedroom apartment in exclusive character townhouse
- Fabulous location in the heart of Tetbury
- Light and airy living room overlooking communal gardens
- Fitted kitchen with appliances
- Available with parking (£50/month)
- Council Tax Band A (Cotswolds)
- EPC Rating C
- Heating, electricity and water bills included
- Single occupancy only and no pets

## SUMMARY

Located in the heart of Tetbury, this compact ground floor two bedroom apartment is for single occupancy. Rent is inclusive of heating, electricity and water. Sorry, no pets.

## DESCRIPTION

Built in 2020, Peter Herve House is an attractive and characterful apartment block of 9 flats with an entrance hall and communal gardens.

Flat 3 is located on the ground floor and is suitable for single occupancy. At the heart of the property is a light and cosy living room with lovely views over the gardens. The kitchen extends off the living room and is complete with fitted cabinets, electric oven, hob and cooker hood, fridge and washing machine. There is a single bedroom and the bathroom has a walk-in shower. The rent is inclusive of heating, electricity and the water, and an allocated car parking space is available for £50 per month. Note that pets are not allowed in the building.

## LOCATION

Tetbury is a thriving and historic market town situated within the Cotswold Area of Outstanding Natural Beauty. The town is well known for its royal connections, with King Charles' Highgrove House and Princess Anne's Gatcombe House both close by, and the beautiful Westonbirt Arboretum also less than 10 minutes drive away. Tetbury town centre offers a broad range of shops and amenities for everyday needs including a large supermarket, hospital, and a post office. There are also a number of quality boutiques, delicatessans and antique shops, some excellent restaurants and cafes, as well as a busy social scene catering for all ages. Conveniently located less than half an hour from both the M4 and M5 motorways, Tetbury is within easy reach of Cirencester, Cheltenham, Bath, Bristol and Swindon. There is good access to nearby Kemble Railway Station which provides regular fast services to London and other regional centres.



1



1



1



C

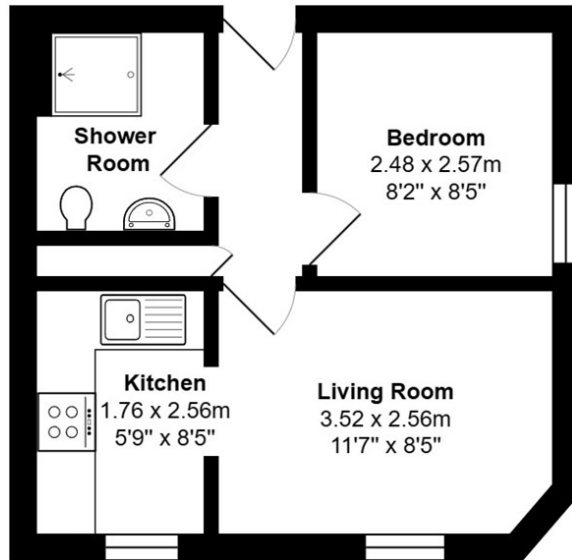

Total Area: 28.7 m<sup>2</sup> ... 309 ft<sup>2</sup>

All measurements are approximate and for display purposes only

## REQUIRED INFORMATION

We understand the property has mains electricity, water, drainage and communal gas fired central heating. Superfast broadband is available in this area; mobile coverage is classed as good outdoors and in-home – please check the Ofcom website for more information. We are not aware of any issues of potential impact including building safety, planning permission or proposed developments, flood risk, and other restrictions.

## DIRECTIONS

From the Market Place roundabout in the centre of Tetbury, head northeast onto Chipping Street. Take the first left onto The Chipping (opposite The Chippings car park) and follow the road round to the left. Then turn right into a small car park and Peter Herve House is in front of you

Postcode: GL8 8EH

What3Words:  
///caused.wisely.realm

## CONTACT

lettings@victoriaallman.co.uk  
01666 338866

www.victoriaallman.co.uk

Energy Efficiency Rating		Current	Potential
Very energy efficient - lower running costs			
(92 plus) <b>A</b>			
(81-91) <b>B</b>			
(69-80) <b>C</b>		73	74
(55-68) <b>D</b>			
(39-54) <b>E</b>			
(21-38) <b>F</b>			
(1-20) <b>G</b>			
Not energy efficient - higher running costs			
<b>England &amp; Wales</b>	EU Directive 2002/91/EC		



**Victoria Allman**  
lettings