



Byways | | Yateley | GU46 6NE

Offers Over £475,000

Freehold



Byways |
Yateley | GU46 6NE
Offers Over £475,000

No Onward Chain! A well-presented four-bedroom semi-detached family home featuring three reception rooms, a garage, and off-street parking.

- Four generous bedrooms
- Semi detached family home
- Off street parking for three cars
- 14ft re fitted kitchen/breakfast room
- Living room with separate dining room
- Family room with access to rear garden
- Integral garage
- Four-piece bathroom
- Enclosed rear garden
- Gas central heating

Location

The property is ideally situated in a cul-de-sac within this popular location, within walking distance of local shops and schools. Frequent bus services operate nearby, providing convenient access to the towns of Camberley, Bracknell, and Farnborough. Junction 4 of the M3 is just a short drive away, offering easy travel to London and the South. Both Farnborough and Fleet mainline stations are also within a short drive and provide fast services to London Waterloo. Yateley Common is just a few minutes' walk from the property and offers miles of excellent countryside for walking.

Description

Offered to the market with no onward chain is this





well-presented four-bedroom semi-detached family home. The spacious accommodation includes an entrance hall with a downstairs cloakroom and a personnel door leading to the 16ft integral garage, as well as a re-fitted kitchen/breakfast room—ideal for everyday family living.

The ground floor offers three generous reception areas: a comfortable living room, a formal dining room, and a versatile family room that overlooks the enclosed rear garden—perfect for entertaining or relaxing.

Upstairs, the property features four well-proportioned bedrooms and a modern four-piece family bathroom, providing ample space for a growing family.

Outside, at the front, there is a driveway with off-street parking leading to the integral garage and gated side access. To the rear, there is an enclosed garden with a timber-built shed.





Byways, Yateley, GU46

Approximate Area = 1181 sq ft / 109.7 sq m
Garage = 128 sq ft / 11.9 sq m
Total = 1309 sq ft / 121.6 sq m
For identification only - Not to scale

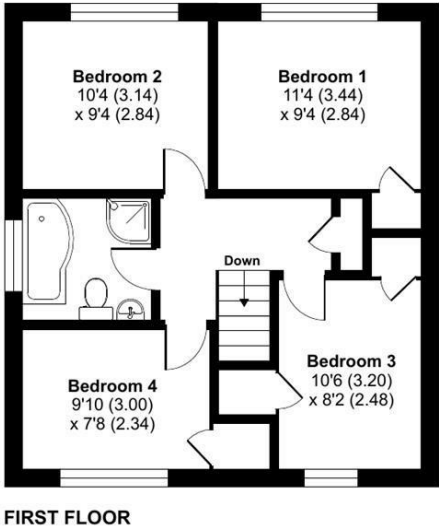
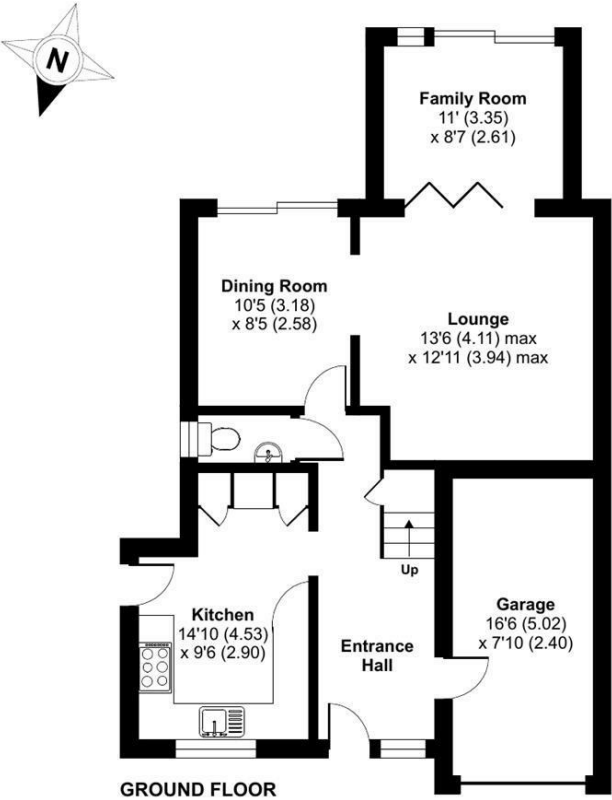

Floor plan produced in accordance with RICS Property Measurement 2nd Edition, Incorporating International Property Measurement Standards (IPMS2 Residential). © nitchecom 2025. Produced for Waterfords. REF: 1306762

Waterfords
Residential Sales & Lettings

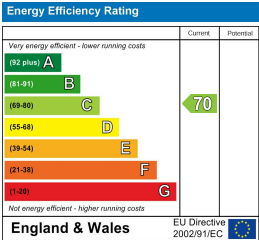

35 Plough Road
Yateley
Hampshire
GU46 7UW
01252 870222

yateley@waterfords.co.uk