



Lytham Court | Cardwell Crescent | Sunninghill | SL5 9BU

£1,100 PCM

Waterfords
Residential Sales & Lettings



GROUND FLOOR
486 sq.ft. (45.1 sq.m.) approx.

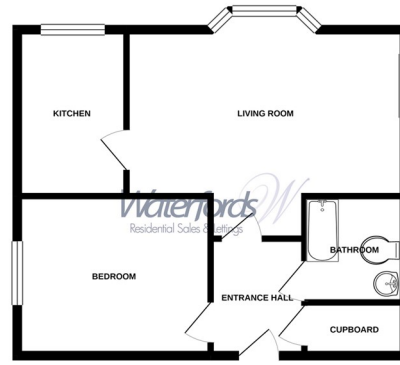

TOTAL FLOOR AREA: 486 sq.ft. (45.1 sq.m.) approx.
Waterfords Residential Sales & Lettings

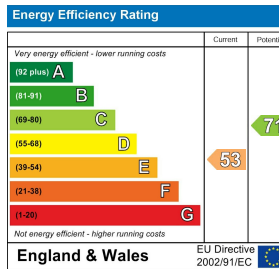

Description

Waterfords is pleased to present this exceptional one-bedroom apartment, ideally located in the highly sought-after area of Sunninghill. Situated on the ground floor, the property offers convenient access to the High Street, train station, and a range of local amenities. Available for immediate occupancy.

Key features

- One Bedroom Apartment
- Unfurnished With White Goods
- Ground Floor
- Communal Gardens
- Council Tax Band C
- Morden Finish Throughout
- Close to Town Centre & Train Station
- Available Now
- Gated Development
- Minimum 12 Month Let



35 Plough Road
Hampshire
GU46 7UW
01276 903006

surreylettings@waterfords.co.uk
<https://www.waterfords.co.uk/>