



Ripon Close | | Camberley | GU15 1BP

Price Guide £450,000 Freehold

*Waterford's* W  
Residential Sales & Lettings

Ripon Close |  
Camberley | GU15 1BP  
Price Guide £450,000

Situated in a no through road on the popular Heatherside development, this 3 bedroom linked-detached home enjoys a secluded rear garden and benefits from a garage and utility room. No onward chain.

- 3 bedrooms
- Kitchen
- Modern shower room
- Garage
- 21ft living/dining room
- Utility room
- Secluded garden
- No through road

### Accommodation

The front door opens to an entrance hall with a downstairs cloakroom, a door opens to the dual aspect L-shaped living room, patio doors open to the rear. The kitchen has a good range of cabinets, a range of appliances and a glazed door opens to the utility room and a door gives access to the garage.



No onward chain



## Outside

The property is approached by a driveway leading to the garage, a small lawned area with path gives access to the front door. The secluded rear garden has a full width patio and leads to a level lawn enclosed by timber fences and bordered by a variety of planting. A door gives access to the utility room.

## Location

The property is located in a no through road on the popular and established Heatherside development with a range of facilities including a Sainsbury's Local, Easy access to great commuter links via the A30/M3 and excellent local schools including Ravenscote



Ripon Close, Camberley, GU15 1BP

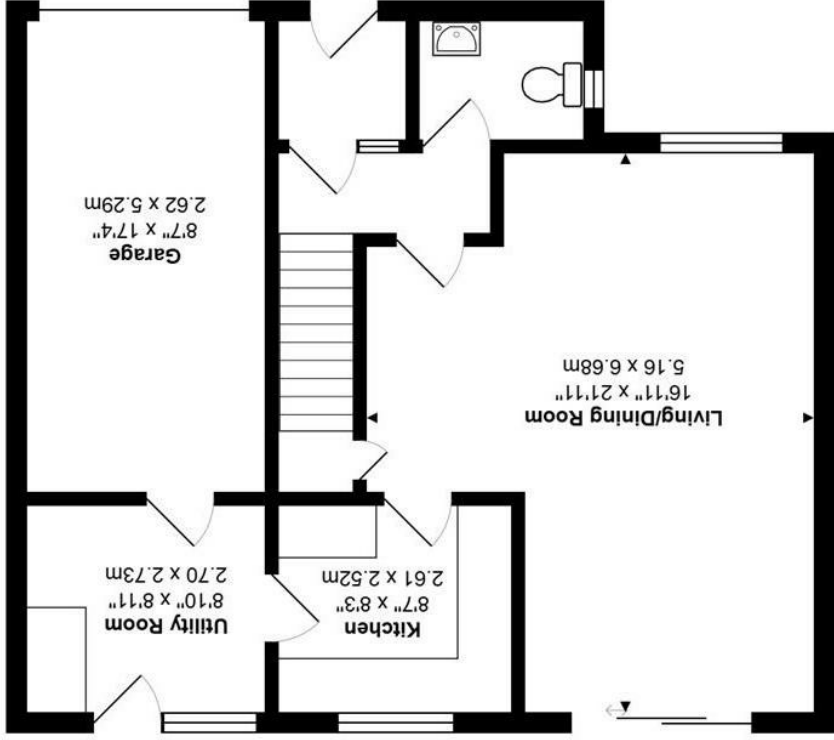

Total Area: 1168 ft<sup>2</sup> ... 108.5 m<sup>2</sup> Including Garage  
All measurements are approximate and for display purposes only

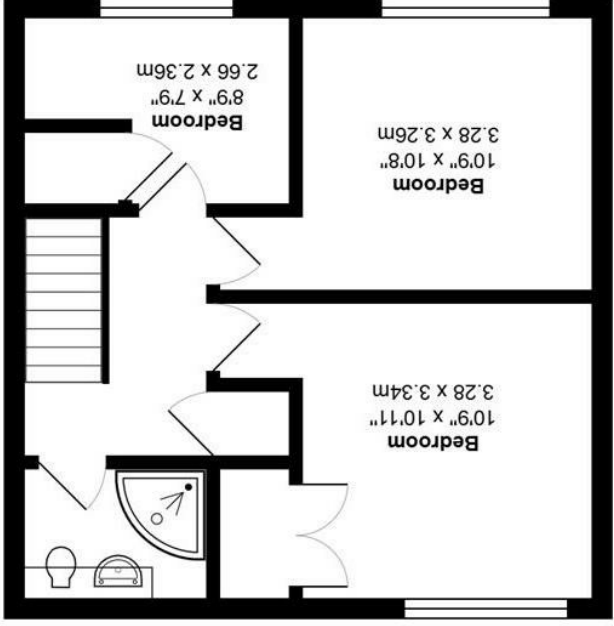

Energy Efficiency Rating	
Current	Target
Very energy efficient - lower running costs	
A	A
B	B
C	C
D	D
E	E
F	F
G	G
Not energy efficient - higher running costs	
EU Directive 2002/91/EC	

27 High Street  
Camberley  
Surrey  
GU15 3RB  
01276 66566  
camberley@watertords.co.uk