



Waterside Court | Fleet | Hants | GU51 2RH

£1,250 PCM

*Waterfords* W  
Residential Sales & Lettings



**WATERSIDE COURT**  
 Whilst every attempt has been made to ensure the accuracy of the floor plan contained here, measurements of doors, windows, rooms and any other items are approximate and no responsibility is taken for any error, omission, or mis-statement. This plan is for illustrative purposes only and should be used as such by any prospective purchaser. The services, systems and appliances shown have not been tested and no guarantee as to their operability or efficiency can be given.  
 Made with Metropix (2020)

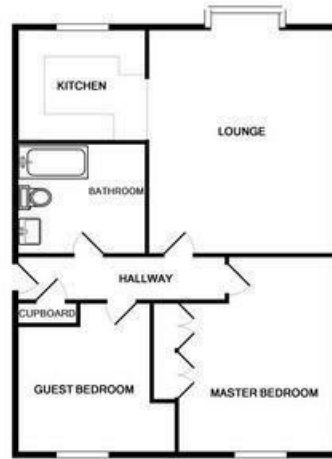

Energy Efficiency Rating		
	Current	Potential
Very energy efficient - lower running costs		
(92 plus) <b>A</b>		
(81-91) <b>B</b>		
(69-80) <b>C</b>		
(55-68) <b>D</b>		
(39-54) <b>E</b>	59	64
(21-38) <b>F</b>		
(1-20) <b>G</b>		
Not energy efficient - higher running costs		
<b>England &amp; Wales</b>	EU Directive 2002/91/EC	



## Description

Waterfords are delighted to present this modern two bedroom ground floor flat, available for rent on a unfurnished basis from 10th October 2025.

## Key features

- Two Bedrooms
- Allocated Parking
- Available 10th October 2025
- Minimum Term 6 Month Let
- Good Size Living Space
- Walking Distance to Fleet Train Station
- Unfurnished



39 The Hart Centre  
 Fleet  
 Hampshire  
 GU51 3LA  
 01252 623330

[hampshirelettings@waterfords.co.uk](mailto:hampshirelettings@waterfords.co.uk)  
<https://www.waterfords.co.uk/>