

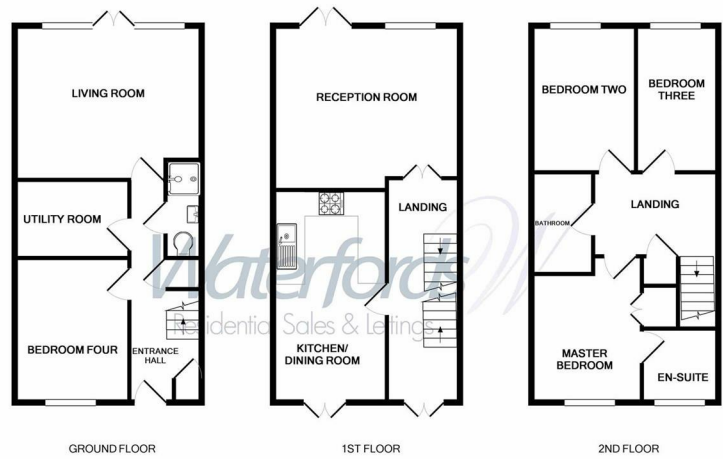

Turners Avenue | Elvetham Heath | Fleet | GU51 1DX

£2,000

Waterfords W
Residential Sales & Lettings



Whilst every attempt has been made to ensure the accuracy of the floor plan contained here, measurements of doors, windows, rooms and any other items are approximate and no responsibility is taken for any error, omission, or mis-statement. This plan is for illustrative purposes only and should be used as such by any prospective purchaser. The services, systems and appliances shown have not been tested and no guarantee as to their operability or efficiency can be given.
Made with Metropix ©2017

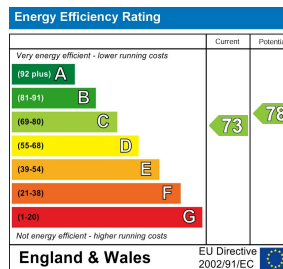

Description

Waterfords are delighted to present this spacious four bedroom family home, available for rent on a unfurnished basis from 6th February 2025. The property has had new carpets and was recently redecorated which is not reflected in the marketing, pets are also welcome.

Key features

- A beautifully presented, spacious four-bedroom townhouse in the highly sought-after Elvetham Heath development.
- First-floor features a modern kitchen/dining room with a Juliet balcony, and a generously proportioned reception room ideal for relaxing and entertaining.
- A sleek and modern family bathroom completes the second floor, catering to family needs.
- The property benefits from a garage and allocated parking.
- Available from early October on an unfurnished basis.
- Ground floor accommodation includes a welcoming entrance hallway, large living room, modern shower room, utility room, and a versatile fourth bedroom.
- Second floor comprises three well-sized bedrooms, including a master bedroom with an en suite shower room.
- Externally, the property offers a low-maintenance rear garden, perfect for outdoor entertaining or relaxing
- Ideally located for commuters, with easy access to the M3, M25, and A30, offering excellent transport links to surrounding areas.
- Council Tax Band: F



39 The Hart Centre
Fleet
Hampshire
GU51 3LA
01252 623330
hampshirelettings@waterfords.co.uk
<https://www.waterfords.co.uk/>