

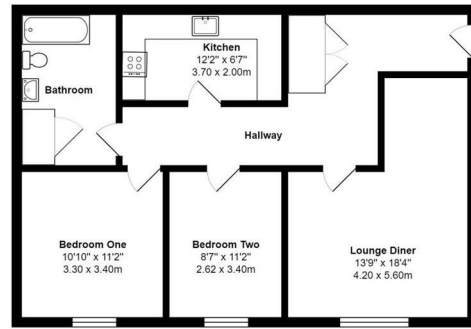

Old Dairy Close | | Fleet | GU51 3SJ

£1,250 Per Calendar Month

Waterfords W
Residential Sales & Lettings



Total Area: 646 ft² ... 60.0 m²
 All measurements are approximate and for display purposes only

Energy Efficiency Rating		Current	Potential
Very energy efficient - lower running costs			
(92 plus)	A		
(81-91)	B		
(69-80)	C		
(55-68)	D		
(39-54)	E		
(21-38)	F		
(1-20)	G		
Not energy efficient - higher running costs			
England & Wales		EU Directive 2002/91/EC	

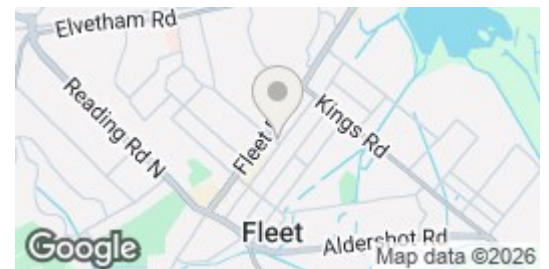

Description

A spacious first-floor apartment set within a secure gated development in the heart of Fleet. Features include a large lounge/diner, modern kitchen, two double bedrooms, and a family bathroom. Further benefits include allocated parking, communal storage, and secure entry system. Just a short walk from Fleet station and town centre amenities.

Key features

- Two Centre Location
- First-floor apartment within a gated development
- Secure telecom entry system for added privacy and convenience
- Well-equipped kitchen with plenty of storage and workspace
- Communal bike storage and bin store within the development
- Two double bedrooms with ample space
- Allocated parking space
- Council Tax Band C EPC C
- Available Now Unfurnished
- 12 Month Let with a 6 Month Break Clause



39 The Hart Centre
 Fleet
 Hampshire
 GU51 3LA
 01252 623330
hampshirelettings@waterfords.co.uk
<https://www.waterfords.co.uk/>