

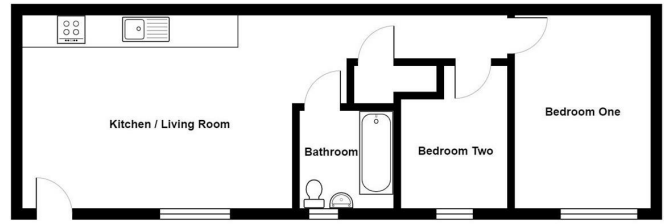

Fairview House | Ashwood Park | Ashwood Way | RG23 8DP

£1,220 PCM

*Waterfords*   
Residential Sales & Lettings



Total Area: 571 ft² ... 53.1 m²



Energy Efficiency Rating		
	Current	Potential
Very energy efficient - lower running costs		
(92 plus) A		
(81-91) B		
(69-80) C		
(55-68) D		
(39-54) E		
(21-38) F		
(1-20) G		
Not energy efficient - higher running costs		
England & Wales	EU Directive 2002/91/EC	



## Description

Contemporary One-Bedroom Apartment at Fairview House, Basingstoke

Beautifully finished one-bedroom apartment in the popular Fairview House development.

Offering a bright open-plan living space, modern kitchen, spacious double bedroom, and a sleek bathroom. Conveniently located near Basingstoke town centre, transport links, and local shops—ideal for professionals or couples seeking stylish and convenient living.

## Key features

- Two Bedroom Maisonette to rent
- Water & electric separately metered
- Intergrated fridge freezer, dishwasher, ceramic hob & electric oven
- Rain shower & heated towel rail
- Available June 2025
- Combination blinds partial or full black-out
- Lightning fast Fibre Broadband plus TV, telephone & Sky Q points.
- LED mirror with shaver socket & demister function
- Onsite parking included in the rent
- 12 Month Minimum Term Let



39 The Hart Centre  
Fleet  
Hampshire  
GU51 3LA  
01252 623330

[hampshirelettings@waterfords.co.uk](mailto:hampshirelettings@waterfords.co.uk)  
<https://www.waterfords.co.uk/>