





Lower Mill, Manafon, Welshpool, Powys, SY21 8BW
Guide Price £435,000

Roger Parry & Partners have been favoured to market this character two bedroomed dwelling with former two storey mill, range of traditional outbuildings and approximately 5.38 acres (2.18 ha) of agricultural land, extending as a whole to approximately 7.33 acres (2.97 ha). The house is situated in a tranquil location looking out over the river and set in large lawned and shrubbed gardens with useful outbuildings. The property provides a wealth of opportunity for extending the existing living accommodation into the former mill building which is currently used as a workshop/storage (subject to gaining the relevant permissions). The property benefits from two large paddocks suitable for agriculture, equestrian or amenity use.



Roger Parry & Partners have been favoured to market this character two bedroomed dwelling with former two storey mill, range of traditional outbuildings and approximately 5.38 acres (2.18 ha) of agricultural land, extending as a whole to approximately 7.33 acres (2.97 ha). The house is situated in a tranquil location looking out over the river and set in large lawned and shrubbed gardens with useful outbuildings. The property provides a wealth of opportunity for extending the existing living accommodation into the former mill building which is currently used as a workshop/storage (subject to gaining the relevant permissions. The property benefits from two large paddocks suitable for agriculture, equestrian or amenity use.

.

SERVICES

Mains Electricity

Mains Water

Septic Tank Drainage

METHOD OF SALE

For sale by private treaty.

TENURE

The property is freehold and will be sold with vacant possession.

LOCAL AUTHORITY

Powys County Council

WAYLEAVE, EASEMENTS AND RIGHTS OF WAY

The property is sold subject to and with the benefit of all rights including rights of way, whether public or private, light, drainage, water and electricity supplies and any other rights and obligations, easements and proposed wayleaves for masts, pylons, stays, cables, drains and water, gas and other pipes, whether referred to in the Sale details or not.

Fishing rights along the river.

PLANS, AREAS AND SCHEDULES

Plans are for identification and reference purposes only. The purchaser(s) shall be deemed to have satisfied themselves of the description of the property. Any error or mis-statement shall not annul a sale or entitle any party to compensation.

Floor Plan
(not to scale - for identification purposes only)

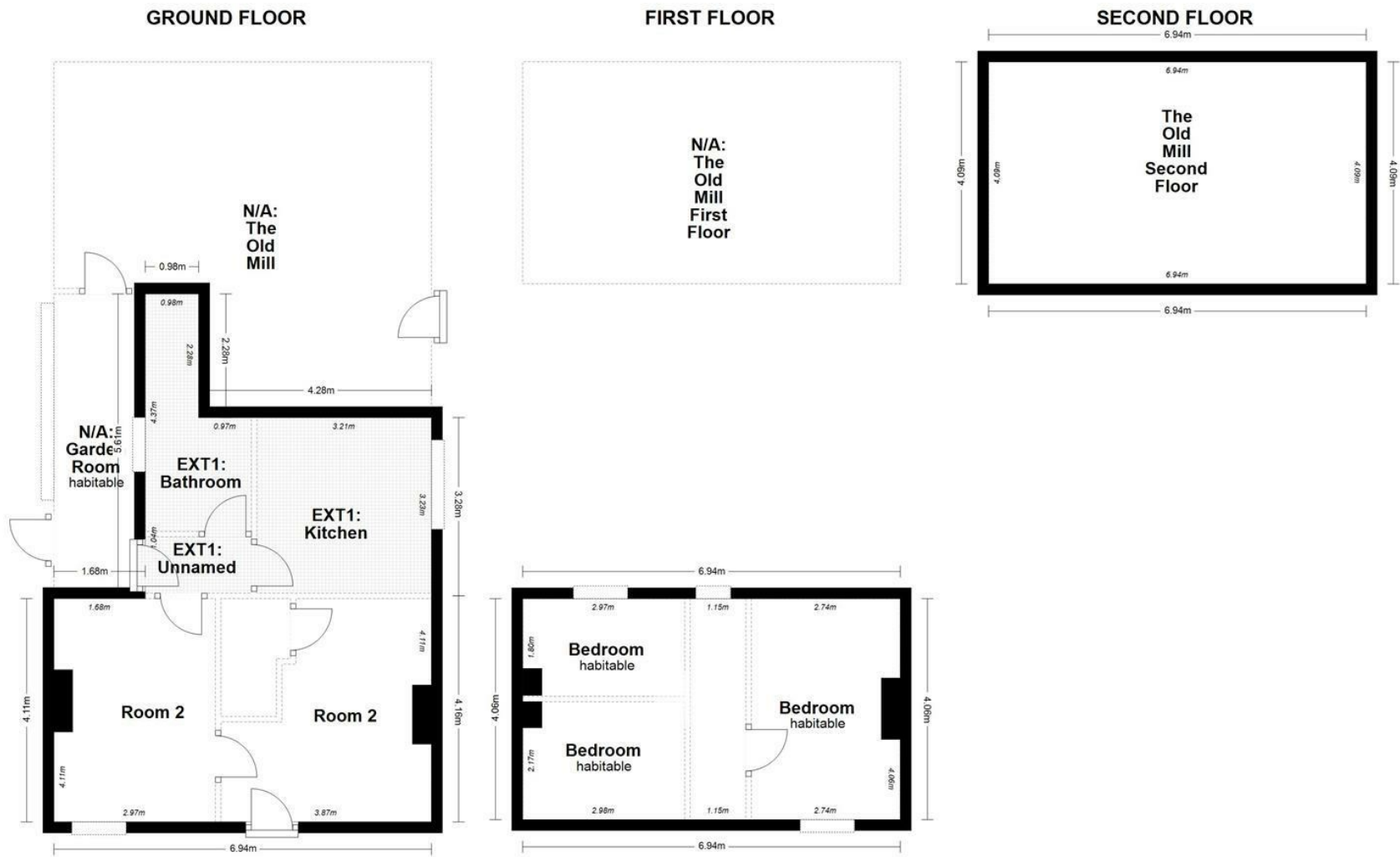

General Services:

Local Authority: Powys County Council

Council Tax Band: E

EPC Rating:

Tenure: Freehold

Fixtures and fittings: No fixtures and fittings are necessarily included in the sale unless agreed at point of sale or point of subsequent negotiations.

Wayleaves, rights of way and easements: The property will be sold subject to and with the benefit of all wayleaves, easements, and rights of way, whether mentioned in these particulars or not.

Directions:

///reactions.relax.widgets

Viewing arrangements

Viewing of the property is strictly by appointment only through:

Roger Parry & Partners LLP

Please contact our Welshpool Office:

1 Berriew Street, Welshpool, Powys, SY21 7SQ
welshpool@rogerparry.net

01938 554499



Important Notice: 1. Nothing in these particulars shall be deemed to be a statement that the property is in good structural condition or otherwise nor that any of the services, appliances, equipment or facilities are in good working order. Purchasers should satisfy themselves of this prior to purchasing. 2. Any areas, measurements, aspects or distances referred to are given as a GUIDE ONLY and are NOT precise. If such details are fundamental to a purchase, purchasers must rely on their own enquiries. 3. Descriptions of the property are subject and are used in good faith as an opinion and NOT as a statement of fact. Please make further enquiries to ensure that our description is likely to match any expectations you may have. 4. Where any references are made to planning permission or potential uses such information is given by Roger Parry & Partners in good faith. Purchasers should make their own enquiries into such matters prior to the purchase. 5. The photograph(s) depict only certain parts of the property. It should not be assumed that any contents/furniture etc. photographed are included in the sale. It should not be assumed that the property remains as displayed in photograph(s). No assumptions should be made with regards to parts of the property that have not been photographed. 6. These sale particulars have been prepared in all good faith to give a fair overall view of the property. If any points are particularly relevant to your interest in the property, please ask for further information.