

173 GREENWOOD CRESCENT

WARRINGTON, WA2 0EB

£975 PER MONTH

Welcome to Greenwood Crescent - this three bedroom end terraced property presented in very good condition in a very popular and residential location. The very well sized property is carpeted throughout and provides three generous bedrooms to the first floor. Garage and utility room to rear along with private rear yard and front garden.

Open plan lounge/dining room to ground floor opening onto a well fitted modern kitchen.

Please give 222 Estates a call to book a viewing straight away!



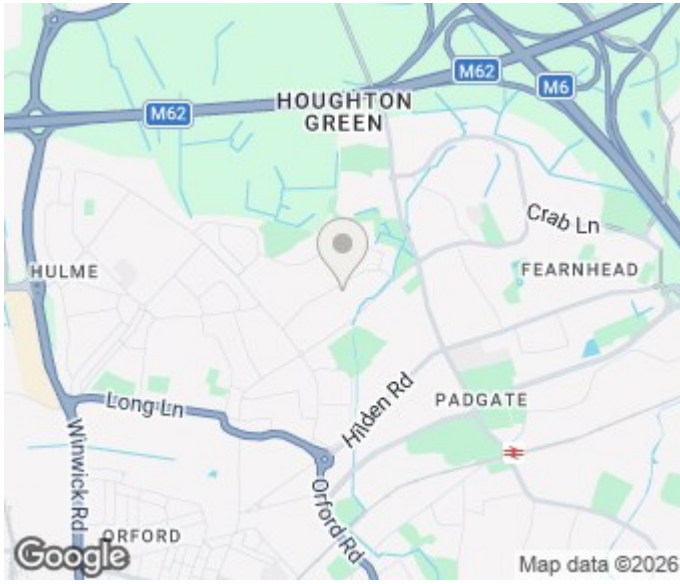
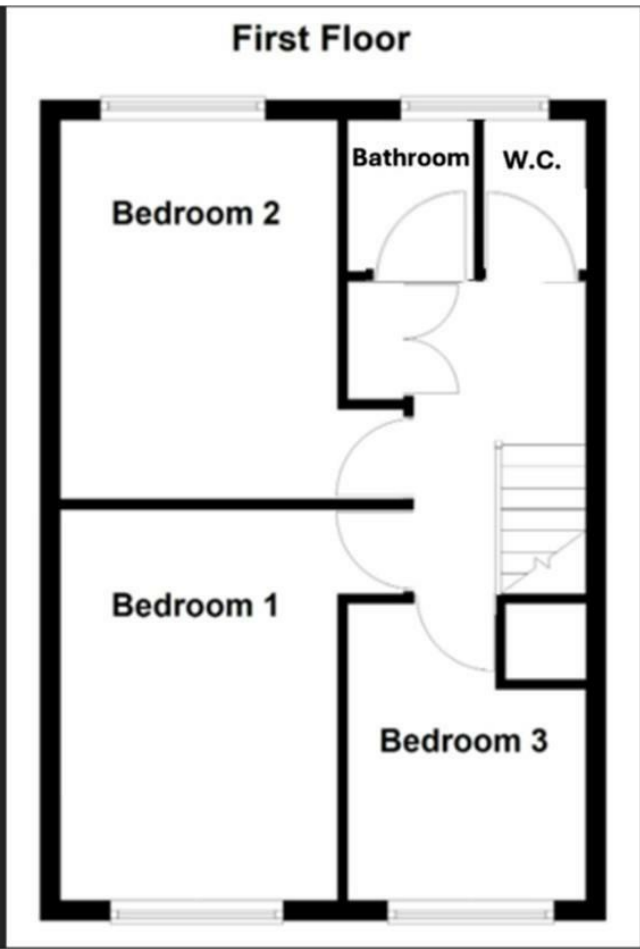

Energy Efficiency Rating	
	Current Potential
Very energy efficient - lower running costs	
(92 plus) A	
(81-91) B	
(69-80) C	
(55-68) D	
(39-54) E	
(21-38) F	
(1-20) G	
Not energy efficient - higher running costs	
England & Wales	EU Directive 2002/91/EC

Current	Potential
	85
72	

Agents Note: Whilst every care has been taken to prepare these particulars, they are for guidance purposes only. All measurements are approximate and are for general guidance purposes only and whilst every care has been taken to ensure their accuracy, they should not be relied upon and potential buyers/tenants are advised to recheck the measurements

222 Estates Sales and Lettings
 222 Orford Lane Orford
 Warrington
 Cheshire
 WA2 7BB

01925 499599
 info@222estates.co.uk
 www.222estates.co.uk

