



15 GLOSSOP CLOSE

WARRINGTON, WA1 2GS

£260,000
FREEHOLD

Tucked away in a quiet cul-de-sac, this well-presented three-bedroom semi-detached home offers both space and comfort in one of the most sought-after spots on the estate. With generous external space to the front and rear, it's perfectly suited for young families and those looking to put down long-term roots.



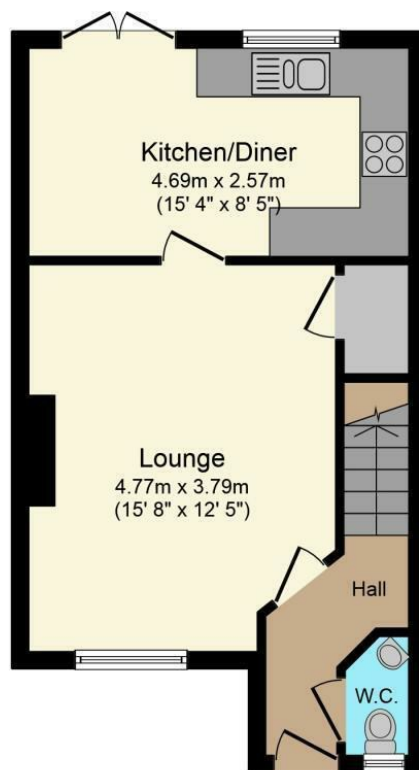

Ground Floor

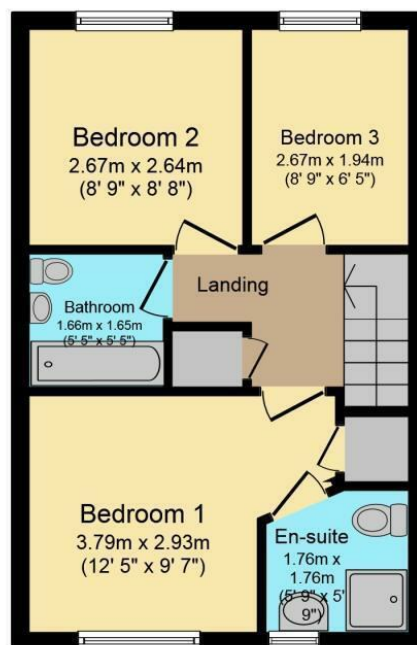

First Floor

Whilst every attempt has been made to ensure the accuracy of this floor plan, all measurements are approximate and no responsibility is taken for any error, omission or misstatement. This plan is for illustration purposes only and may not be representative of the property. Plan not to scale. Specifically no guarantee is given on the total square footage of the property if shown on this plan. Any figure given is for initial guidance only and should not be relied on as a basis of valuation. Plan produced for Purple Bricks. Powered by PropertyBOX



Energy Efficiency Rating		
	Current	Potential
Very energy efficient - lower running costs		
(92 plus) A		
(81-91) B		
(69-80) C		
(55-68) D		
(39-54) E		
(21-38) F		
(1-20) G		
Not energy efficient - higher running costs		
England & Wales	EU Directive 2002/91/EC	

Agents Note: Whilst every care has been taken to prepare these particulars, they are for guidance purposes only. All measurements are approximate and are for general guidance purposes only and whilst every care has been taken to ensure their accuracy, they should not be relied upon and potential buyers/tenants are advised to recheck the measurements

222 Estates Sales and Lettings
222 Orford Lane Orford
Warrington
Cheshire
WA2 7BB

01925 499599
info@222estates.co.uk
www.222estates.co.uk

