



3 HUGHES PLACE WARRINGTON, WA2 9EJ

£165,000
FREEHOLD

Nestled in the charming area of Hughes Place, Orford, Warrington, this delightful semi-detached terrace house offers a perfect blend of comfort and convenience. Built in the late 1950s, the property exudes a sense of character while providing modern living spaces suitable for families or professionals alike. Tenant in Situ, but NO CHAIN



GROUND FLOOR
357 sq.ft. (33.1 sq.m.) approx.

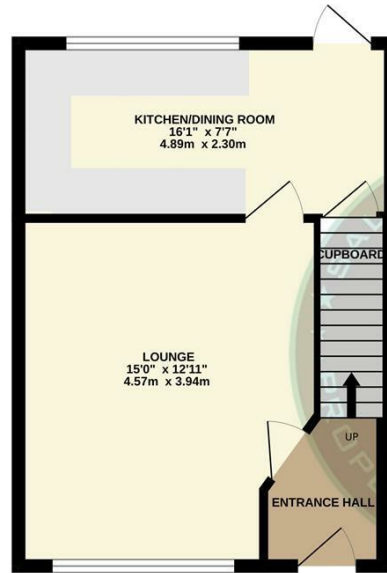

1ST FLOOR
447 sq.ft. (41.5 sq.m.) approx.

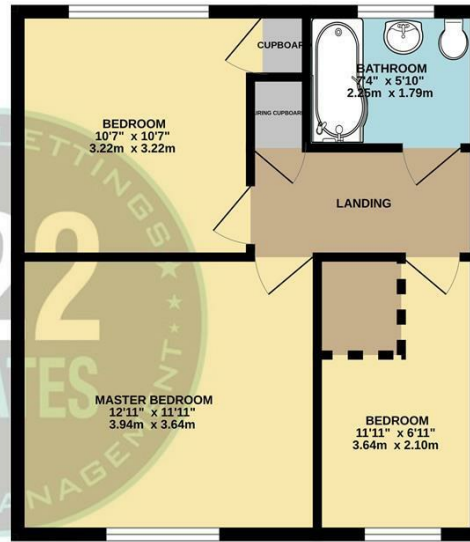

3 BEDROOM TERRACE

TOTAL FLOOR AREA : 803 sq.ft. (74.6 sq.m.) approx.

Whilst every attempt has been made to ensure the accuracy of the floorplan contained here, measurements of doors, windows, rooms and any other items are approximate and no responsibility is taken for any error, omission or mis-statement. This plan is for illustrative purposes only and should be used as such by any prospective purchaser. The services, systems and appliances shown have not been tested and no guarantee as to their operability or efficiency can be given.
Made with Metropix ©2026

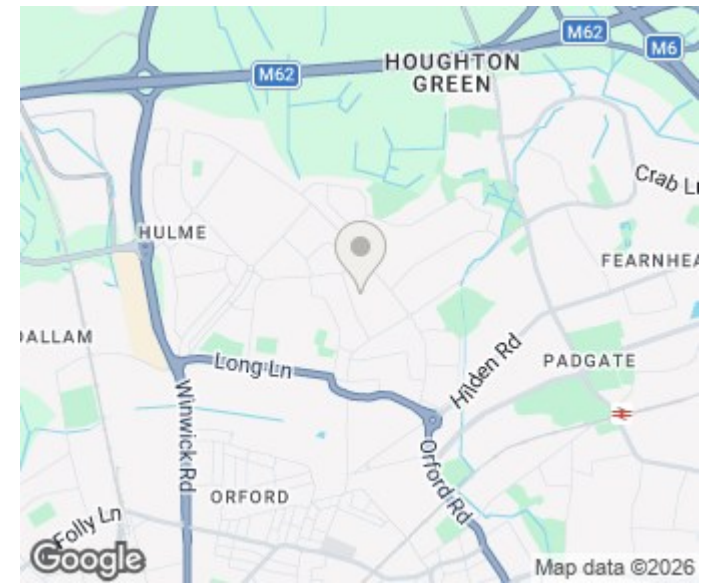

Energy Efficiency Rating		Current	Potential
Very energy efficient - lower running costs			
(92 plus) A			
(81-91) B			88
(69-80) C		73	
(55-68) D			
(39-54) E			
(21-38) F			
(1-20) G			
Not energy efficient - higher running costs			
England & Wales		EU Directive 2002/91/EC	

Agents Note: Whilst every care has been taken to prepare these particulars, they are for guidance purposes only. All measurements are approximate and are for general guidance purposes only and whilst every care has been taken to ensure their accuracy, they should not be relied upon and potential buyers/tenants are advised to recheck the measurements

222 Estates Lettings and Sales
222 Orford Lane Orford
Warrington
Cheshire
WA2 7BB

01925 499599
info@222estates.co.uk
www.222estates.co.uk

