

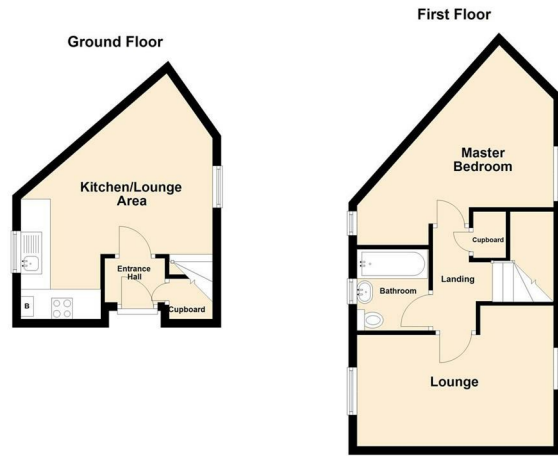

4 | Hughes Court | Hethersett | NR9 3PT

£800 PCM

 **BUTTERFLY** 
LETTINGS & PROPERTY MANAGEMENT



Every effort has been made to ensure the accuracy of the floorplan provided. However, measurements of doors, windows, rooms, and other items are approximate, and no responsibility is accepted for any errors, omissions, or inaccuracies. This floorplan is for illustrative purposes only and should be used as such by prospective tenants. The services, systems, and appliances depicted have not been tested, and no guarantee is made regarding their functionality or efficiency. Plan produced using PlanUp.

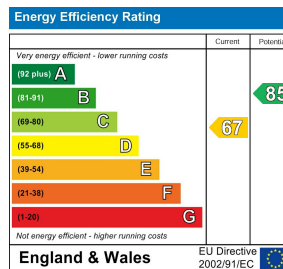

Description

This mid terraced coach house is situated in a cul-de-sac, offering flexible accommodation & a convenient location. The property features an entrance hall with under-stair storage, leading to a spacious open-plan kitchen living area on the ground floor. The first floor comprises of a Lounge, double bedroom and a bathroom. Benefiting from gas central heating and double glazing.

Externally, the property boasts two allocated parking spaces located to the rear, offering added convenience. Ideally positioned for easy access to village amenities, green spaces, and transport links, this home is perfectly suited for modern living. Available immediately.

Key features

- Mid Terraced coach house in popular location
- Entrance hall with useful under-stair storage
- Open-plan Kitchen living area on the ground floor
- First floor Lounge & double bedroom
- First floor Bathroom
- Gas central heating and double glazing
- Two allocated parking spaces located to the rear
- Set within a cul-de-sac location
- Ideally positioned for village amenities and transport links
- Available end of April



6 Church Lane

Eaton, NR4 6NZ

hello@butterflylettings.co.uk

<https://www.butterflylettings.co.uk>

01603 870870

While we have made every effort to ensure that these details provide a fair and accurate representation of the property at the time of listing, they are intended for guidance only. Please be aware that we do not consult with management companies, planning departments, or building control in preparing these details. We strongly recommend that you review the property and its surrounding area on Google Maps and Street View before scheduling a viewing. Note that the photographs do not imply that any depicted items are included, the quoted measurements are approximate, and the fixtures, fittings, and appliances have not been tested, so their functionality cannot be guaranteed. If any specific detail is particularly important to you, we advise seeking professional verification.