

19 Beacon Drive
Wideopen
Newcastle Upon Tyne
NE13 7HA

Guide Price
£240,000



19 Beacon Drive
Wideopen
Newcastle Upon Tyne
NE13 7HA

- 3 Double Bedroom Detached Bungalow
- Conservatory
- Gas Central Heating
- Large Garage
- Council Tax Band C
- Driveway Parking for up to 4 Cars
- Recently Installed Wetroom
- Sealed Unit Double Glazed Windows
- Low Maintenance Garden
- EPC D





Ground Floor

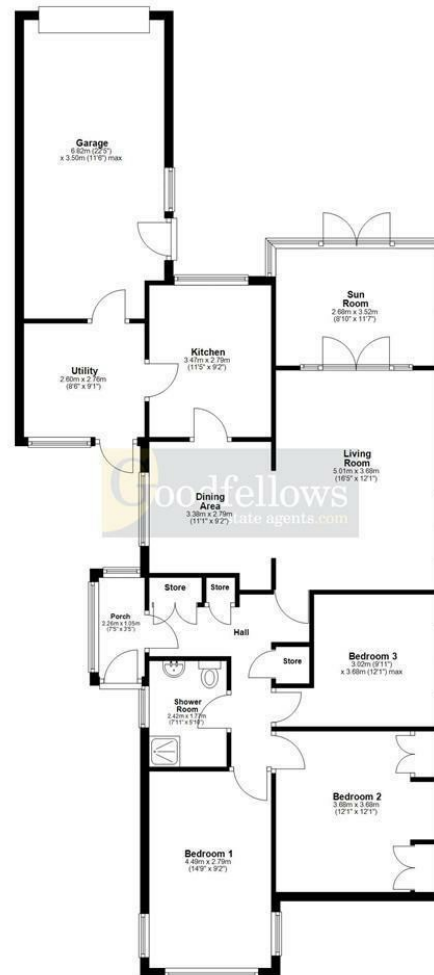

Total area: approx. 130.4 sq. metres (1403.7 sq. feet)

Whilst every attempt has been made to ensure the accuracy of the floor plan contained here, measurements of doors, windows, rooms and any other items are approximate and no responsibility is taken for any error, omission, or mis-statement. The Plan is for illustrative purposes only. Version 1

Plan produced using PlanUp.

EPC Rating: D
Council Tax Band: C

Whilst every care has been taken to prepare these particulars, they are for guidance purposes only. All measurements are approximate and whilst every care has been taken to ensure their accuracy, they should not be relied upon and potential buyers/tenants are advised to recheck the measurements. The agent has not tested any equipment, services, fixtures or fittings and makes no representation regarding their condition.

CONTACT

2 Middleton South, Newcastle Great Park,
Newcastle upon Tyne, NE13 9BJ

E: greatpark@goodfellowsestateagents.com
T: 0191 2848100

Goodfellows
estate agents.com