

2 Somerton Court  
Kingston Park  
Newcastle upon Tyne  
NE3 2QZ

Guide Price  
£275,000



2 Somerton Court  
Kingston Park  
Newcastle upon Tyne  
NE3 2QZ

- 3 Bedroomed Detached House
- Lounge with Fireplace
- Fitted Kitchen
- Attached Garage
- Convenient for Schools, Shops and Metro System
- Convenient Location
- Dining Room with Patio Doors
- Refurbished Bathroom/WC with Separate Shower
- West Facing Enclosed Rear Garden
- A Great Family House







**Ground Floor**  
Floor area 65.9 sq.m. (709 sq.ft.)

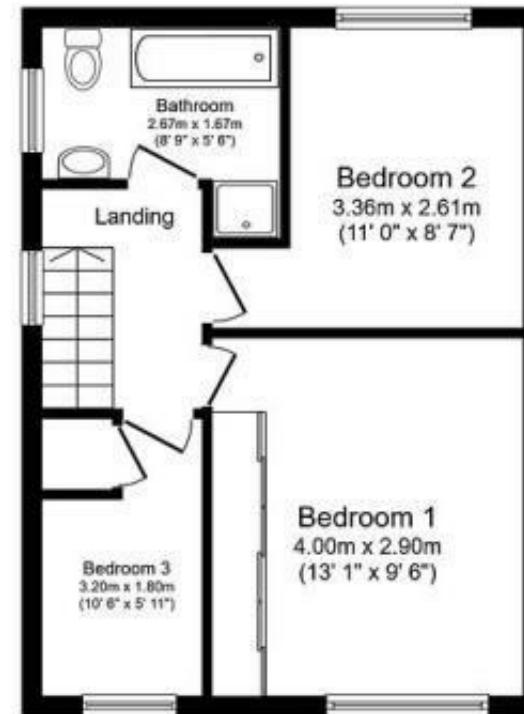

**First Floor**  
Floor area 40.1 sq.m. (432 sq.ft.)

**Total floor area: 106.0 sq.m. (1,141 sq.ft.)**

This floor plan is for illustrative purposes only. It is not drawn to scale. Any measurements, floor areas (including any total floor area), openings and orientations are approximate. No details are guaranteed, they cannot be relied upon for any purpose and do not form any part of any agreement. No liability is taken for any error, omission or misstatement. A party must rely upon its own inspection(s).



**EPC Rating: D**  
**Council Tax Band: C**

Whilst every care has been taken to prepare these particulars, they are for guidance purposes only. All measurements are approximate and whilst every care has been taken to ensure their accuracy, they should not be relied upon and potential buyers/tenants are advised to recheck the measurements. The agent has not tested any equipment, services, fixtures or fittings and makes no representation regarding their condition.

**CONTACT**

2 Middleton South, Newcastle Great Park,  
Newcastle upon Tyne, NE13 9BJ

E: [greatpark@goodfellowsestateagents.com](mailto:greatpark@goodfellowsestateagents.com)  
T: 0191 2848100

